

REQUIRED INFORMATION ON ALL PLOT PLANS

1. OWNER(S) NAME
2. PROPERTY ADDRESS
3. DATE
4. PROJECT DESCRIPTION
5. TYPE OF CONSTRUCTION
6. EXISTING AREA S.F. (DWELLING AND ACCESSORY)
7. PROPOSED AREA S.F. (DWELLING AND ACCESSORY)
8. TOTAL SQUARE FOOTAGE
9. LOT SIZE
10. LOT COVERAGE
11. LOT DIMENSIONS
12. LOCATE ALL BUILDINGS AND STRUCTURES
13. LOCATE YARDS AND SPACE BETWEEN BUILDINGS
14. LOCATE WALLS, FENCES, AND LANDSCAPING
15. LOT COVERAGE
16. SETBACKS (FRONT, REAR, SIDES)
17. LEGAL DESCRIPTION (APN, LOT, TRACT)
18. SUCH OTHER DATA AS MAY BE REQUIRED BY THE PLANNING DIVISION

NOTE:

IF THE PROPOSED ADDITION IS GREATER THAN 20% OF THE EXISTING FLOOR AREA OF THE HOUSE, THE GARAGE MUST PROVIDE FOR A 2-CAR GARAGE (MINIMUM 20' X 20').
(ONLY APPLIES TO SINGLE-CAR GARAGES)

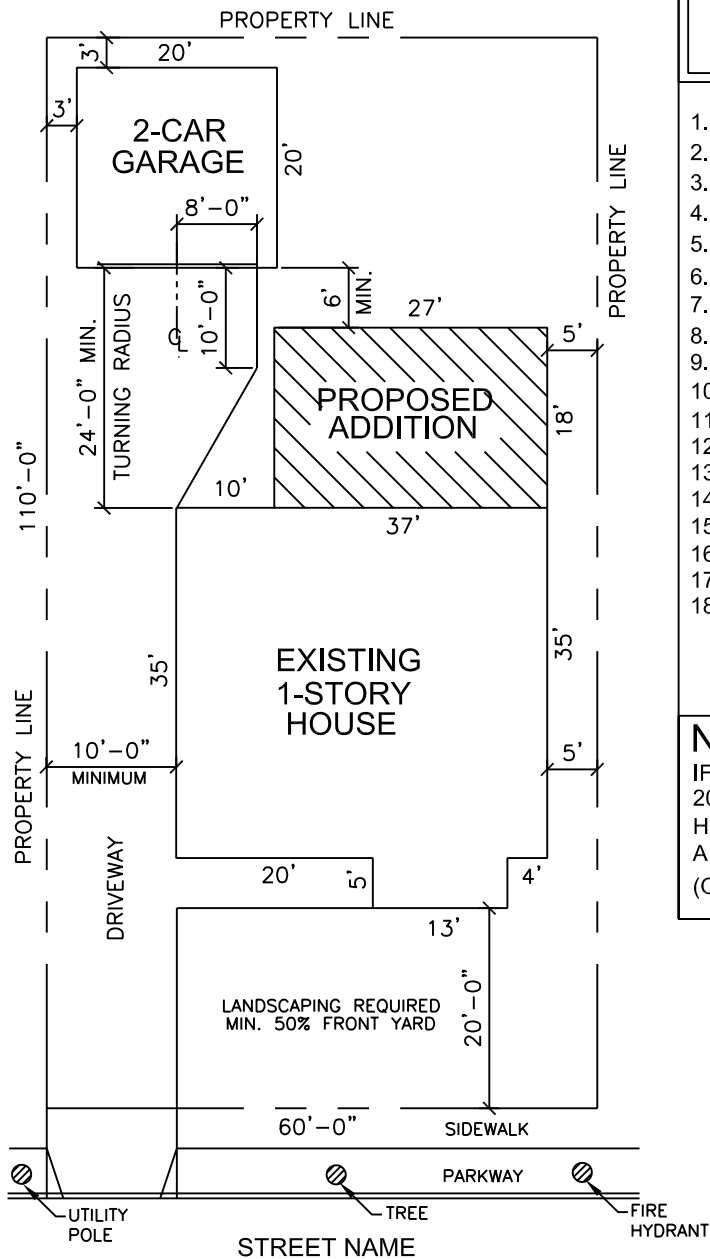

SAMPLE PLOT PLAN



SCALE SHALL NOT BE LESS THAN 1/8" = 1'-0"

PLOT PLAN MUST BE FULLY DIMENSIONED AND TO SCALE

A PLOT PLAN IS REQUIRED FOR ANY RESIDENTIAL ADDITION OR ALTERATION INVOLVING A CHANGE TO THE SITE. A PLOT PLAN SHOULD BE SUBMITTED AS PART OF YOUR PERMIT APPLICATION TO THE COMMUNITY DEVELOPMENT DEPARTMENT.

USE THIS EXAMPLE AS A GUIDE TO DRAW YOUR OWN PLOT PLAN. SHOW AS MUCH INFORMATION AS POSSIBLE. PLANS SHALL BE DRAWN TO SCALE, WITH A STRAIGHT EDGE, AND WITH ENOUGH CLARITY TO SHOW CONFORMANCE WITH APPLICABLE REGULATIONS. ACTUAL CONDITIONS AND REQUIREMENTS MAY DIFFER FROM THIS EXAMPLE.