

GENERAL NOTES

1. ALL WORK SHALL BE PERFORMED IN ACCORDANCE WITH THE FOLLOWING:

A. CITY OF SAN FERNANDO WATER CONSTRUCTION DRAWINGS STANDARDS.

B. STANDARD SPECIFICATION FOR PUBLIC WORKS CONSTRUCTION

C. AWWA STANDARD SPECIFICATIONS

D. STANDARD PLANS FOR CONSTRUCTION OF LOCAL STREETS AND ROADS.

E. JULY 2006 (STATE OF CALIFORNIA)

F. PROJECT SPECIFICATIONS

G. COUNTY OF LOS ANGELES PRIVATE CONTRACT SANITARY SEWER CONSTRUCTION OF SANITARY SEWER.

H. AWWA STD SPECIFICATIONS, LATEST EDITION
2. THE CONTRACTOR SHALL NOTIFY THE PROJECT MANAGER FORTY- EIGHT (48) HOURS PRIOR TO STARTING ANY WORK. TELEPHONE NUMBER (818) 888-1222 APPROVAL OF THIS PLAN BY THE CITY OF SAN FERNANDO DEPARTMENT OF PUBLIC WORKS DOES NOT CONSTITUTE A REPRESENTATION AS TO THE ACCURACY OF LOCATION OF OR THE EXISTENCE OR NON-EXISTENCE OF ANY UNDERGROUND UTILITY PIPE OR STRUCTURE WITHIN THE LIMITS OF THIS PROJECT. THIS NOTE APPLIES TO ALL PAGES.
3. THESE PLANS ARE HEREBY MADE A PART OF THE SPECIFICATIONS AND CONTRACTUAL AGREEMENT.
4. NO REVISION SHALL BE MADE TO THESE PLANS WITHOUT THE PRIOR APPROVAL OF THE CITY ENGINEER.
5. THE CONTRACTOR IS TO PROVIDE THE CITY WITH AN AS-BUILT SET OF CONSTRUCTION PLANS
6. THE CONTRACTOR SHALL APPLY FOR ALL NECESSARY CONSTRUCTION PERMITS FOR ALL WORK AS SHOWN ON THESE PLANS FROM THE CITY OF SAN FERNANDO. THE CONTRACTOR MUST CONTACT THE CITY OF SAN FERNANDO DEPARTMENT OF PUBLIC WORKS. TO RESOLVE THE NECESSARY PERMIT & INSPECTION FEES.
7. THE CONTRACTOR SHALL POSSESS A VALID STATE CONTRACTORS LICENSE AND SHALL BE REQUIRED TO POSSESS A VALID CITY BUSINESS LICENSE WHILE PERFORMING WORK ON THIS PROJECT.
8. ANY CONTRACTOR PERFORMING WORK AS INDICATED HEREON FOR THIS PROJECT SHALL FAMILIARIZE HIMSELF WITH THE SITE AND SHALL BE SOLELY RESPONSIBLE FOR ANY DAMAGE TO EXISTING FACILITIES RESULTING DIRECTLY OR INDIRECTLY FROM HIS OPERATIONS, WHETHER OR NOT SUCH FACILITIES ARE SHOWN ON THESE PLANS.
9. THE CONTRACTORS ATTENTION IS EXPRESSLY DIRECTED TO ALL THE REQUIREMENTS AND PROVISIONS OF THE STATE OF CALIFORNIA SAFETY REGULATION. COMPLIANCE THERE TO SHALL BE STRICTLY ENFORCED DURING THE ENTIRE LIFE OF THE CONTRACT.
10. THE CONTRACTOR SHALL DISPOSE OF ALL SURPLUS EARTH EXCAVATION OUTSIDE OF THE PROJECT AREA UNLESS APPROVED OTHERWISE BY THE CITY ENGINEER. ALL AC AND CONCRETE REMOVALS SHALL BE DISPOSED OF OFF-SITE.
11. THE CONTRACTOR SHALL REVIEW AND VERIFY ALL CONDITIONS AND DIMENSIONS AT THE JOB SITE BEFORE COMMENCING ANY PORTION OF THE WORK. COMPARE ACTUAL CONDITIONS WITH DRAWINGS TO ASCERTAIN CONDITIONS UNDER WHICH WORK IS TO BE PERFORMED. THE CONTRACTOR SHALL BE RESPONSIBLE FOR THE STRUCTURES, EQUIPMENT, AND UTILITIES WHICH MAY AFFECT WORK. COMMENCEMENT OF WORK SHALL CONSTITUTE FULL ACCEPTANCE OF EXISTING SITE CONDITIONS. THE CONTRACTOR SHALL REPORT ALL DISCREPANCIES TO THE CITY ENGINEER PRIOR TO THE COMMENCEMENT OF WORK.
12. THE CONTRACTOR SHALL ENACT ALL MEASURES TO PROTECT AND SAFEGUARD WORKERS AND THE GENERAL PUBLIC FROM INJURY DURING THE ENTIRE TIME OF CONSTRUCTION. MAINTAIN THE JOB SITE IN AN ORDERLY, CLEAN MANNER THROUGHOUT THE COURSE OF WORK AND PROTECT ALL EXISTING UTILITIES FROM DAMAGE. REMOVE AND RELOCATE ALL OBSTRUCTIONS FROM THE JOB SITE EACH DAY, AND COMPLY WITH ALL APPLICABLE CODES. ALL CONTRACTORS AND SUBCONTRACTORS SHALL COMPLY WITH THE OCCUPATIONAL SAFETY AND HEALTH REGULATION OF THE U.S. DEPARTMENT OF LABOR, AND THE STATE OF CALIFORNIA DEPARTMENT OF INDUSTRIAL RELATIONS' CONSTRUCTION SAFETY ORDERS." THE CITY ENGINEER SHALL NOT BE RESPONSIBLE IN ANY WAY FOR THE CONTRACTORS' AND SUBCONTRACTORS COMPLIANCE WITH THE OCCUPATIONAL SAFETY AND HEALTH REGULATIONS OF THE U.S. DEPARTMENT OF LABOR OR WITH THE STATE OF CALIFORNIA DEPARTMENT OF INDUSTRIAL RELATIONS AND ALL OTHER SAFETY ORDERS. THE CONTRACTOR SHALL MAINTAIN ADEQUATE LIABILITY INSURANCE AND SHALL BE RESPONSIBLE FOR THE PERFORMANCE OF WORK ON THIS PROJECT, EXCEPTING FOR LIABILITY ARISING FROM THE SOLE NEGLIGENCE OF THE OWNER OR THE ENGINEER.
13. ALL CONCRETE AND ASPHALT CONCRETE PAVEMENT TO BE REMOVED SHALL BE REMOVED UTILIZING A SAW CUT (MINIMUM CUT DEPTH 1 1/2" AND/OR OTHER METHODS AS APPROVED BY THE CITY ENGINEER.
14. CONTRACTOR SHALL POPTHOLE TO VERIFY LOCATION AND DEPTH OF UTILITIES.
15. THE CONTRACTOR SHALL ADJUST ALL UTILITY VALVE BOXES, MANHOLES, ETC. TO GRADE UPON COMPLETION OF PAVING. CONCRETE PAVEMENT SHALL BE USED TO PATCH AROUND RAISED UTILITIES IN CONCRETE STREETS, ASPHALT CONCRETE PAVEMENT IN ASPHALT CONCRETE STREETS. IF PULLBOXES (WATER, GAS, ETC) ARE DAMAGED, CONTRACTOR SHALL REPLACE THEM IN KIND.
16. EXISTING UTILITIES SHALL BE MAINTAINED IN PLACE BY THE CONTRACTOR, UNLESS OTHERWISE NOTED. RELOCATION OR REMOVAL OF ANY EXISTING UTILITIES NOT COVERED BY THESE SPECIFICATIONS SHALL BE THE RESPONSIBILITY OF THE RESPECTIVE UTILITY OWNERS AT THE EXPENSE OF THE CONTRACTOR.
17. CONTRACTOR SHALL PROTECT IN PLACE ANY MAIL BOXES, IRRIGATION SYSTEM, ELECTRICAL CONDUIT, CABLE CONDUIT OR UTILITY LINE. IF DAMAGED DURING CONSTRUCTION, CONTRACTOR SHALL REPLACE IN KIND.
18. THE CONTRACTOR SHALL REPLACE IN KIND, TO THE SATISFACTION OF THE CITY ENGINEER, ANY PAVING, CURB AND GUTTER OR OTHER IMPROVEMENTS CUT, REMOVED, OR DAMAGED IN CONDUCTION WITH THIS PROJECT.
19. THE CONTRACTOR AGREES THAT HE SHALL ASSUME SOLE AND COMPLETE RESPONSIBILITY FOR JOB SITE CONDITIONS DURING THE COURSE OF CONSTRUCTION OF THIS PROJECT, INCLUDING SAFETY OF ALL PERSONS AND PROPERTY, THAT THIS REQUIREMENT SHALL APPLY CONTINUOUSLY AND NOT BE LIMITED TO NORMAL WORKING HOURS; AND THAT THE CONTRACTOR SHALL DEFEND, INDEMNIFY AND HOLD THE CITY, THE CITY ENGINEER AND THEIR REPRESENTATIVE, HARMLESS FROM ANY AND ALL LIABILITY, REAL OR ALLEGED, IN CONNECTION WITH THE PERFORMANCE OF WORK ON THIS PROJECT, EXCEPTING FOR LIABILITY ARISING FROM THE SOLE NEGLIGENCE OF THE CITY OR THE CITY ENGINEER.



FISCAL YEAR 2018-2019 ANNUAL STREET RESURFACING PROJECT

JOB NO. 7597

PLAN NO. P-726

WATER NOTES

20. THE CONTRACTOR SHALL PROVIDE DUST CONTROL AND TRAFFIC CONTROL AT ALL TIMES TO THE SATISFACTION OF THE CITY ENGINEER AND SHALL BE IN COMPLIANCE WITH SOUTH COAST AIR QUALITY MANAGEMENT DISTRICT (A.Q.M.D.) RULE 403 FOR MINIMIZING DUST CONTROL.
21. BARRICADES WITH FLASHING LIGHTS ARE TO BE MAINTAINED ON ALL OBSTRUCTIONS WITHIN EXISTING STREET RIGHT-OF-WAYS AT ALL TIMES. CONSTRUCTION WARNING SIGNS AND FLAGMEN ARE TO BE PRESENT AT THE JOB SITE.
22. THE CONTRACTOR SHALL NOTIFY UNDERGROUND SERVICE ALERT AT 811 TWO (2) DAYS PRIOR TO BEGINNING WORK.
23. THE CONTRACTOR SHALL BE RESPONSIBLE FOR THE PRESERVATION OF ALL, IF ANY, EXISTING SURVEY MONUMENTS.
24. THE CITY SHALL NOT BE RESPONSIBLE FOR, OR LIABLE FOR, UNAUTHORIZED CHANGES TO OR USES OF THESE PLANS. ALL CHANGES TO THE PLANS MUST BE IN WRITING AND MUST BE APPROVED BY THE PROJECT ENGINEER.
25. THE CITY INSPECTOR WILL LAYOUT THE PRECISE LOCATION OF ALL CONCRETE WORK, AC PATCHING AND OTHER IMPROVEMENTS SHOWN ON THE PLANS. THESE IMPROVEMENTS AS SHOWN MAY VARY SLIGHTLY AS TO LOCATION. CONTRACTOR SHALL BE RESPONSIBLE FOR CONSTRUCTION AND QUANTITIES AS MARKED OUT BY THE CITY INSPECTOR.
26. CONTRACTOR SHALL PROVIDE ALL NECESSARY MEANS TO AVOID TRACKING ASPHALT OIL ON EXISTING ASPHALT PAVEMENT OR CONCRETE PAVEMENT DURING OPERATIONS. SEE TECHNICAL SPECIFICATIONS FOR CONDITIONS.
27. CONTRACTOR SHALL BACKFILL AND RESEED LANDSCAPE AS IMPROVEMENT.
28. CONTRACTOR SHALL INSTALL TEMPORARY ASPHALTIC CONCRETE PAVEMENT AS INDICATED BY THE ENGINEER OR INSPECTOR. THE ENGINEER OR INSPECTOR SHALL DETERMINE THE EXACT LOCATION WHERE TEMPORARY RESURFACING WILL BE NEEDED. THE CONTRACTOR SHALL BE RESPONSIBLE FOR THE REMOVAL OF CONCRETE WITH PERMANENT ASPHALTIC CONCRETE, PORTLAND CEMENT CONCRETE, EARTH OR OTHER MATERIALS THAT ARE TO BE REMOVED FROM THE SITE. ALL COSTS INVOLVED IN COMPLYING WITH THE ABOVE REQUIREMENTS SHALL BE INCLUDED IN THE UNIT PRICE BID FOR CLEANING AND GRUBBING.

SEWER NOTES

1. ALL PIPE MATERIAL SHALL BE DUCTILE IRON PIPE OR OTHER APPROVED MATERIAL BY THE CITY.
2. WATER MAIN SHALL BE PRESSURE TESTED AND CHLORINATED IN COMPLIANCE WITH THE CITY'S WATER UTILITY STANDARD SPECIFICATION. THE MAIN SHALL MEET OR EXCEED THE PRESSURE AND CHLORINATION REQUIREMENTS PRIOR TO CONNECTION TO THE CITY'S WATER SYSTEM. DISINFECTION OF ENTIRE PIPELINE SHALL BE IN ACCORDANCE WITH THE LATEST EDITION OF AWWA C601. ALL MAINS INSTALLED ARE TO BE PRESSURE TESTED TO 150PSI. ALL TESTS TO CONFORM TO THE SPECIFICATIONS FOUND IN THE LATEST EDITION OF AWWA STD C-601.
3. THE CITY SHALL REVIEW AND APPROVE ALL MATERIALS PRIOR TO INSTALLATION.
4. SHUT DOWNS SHALL BE COORDINATED WITH THE CITY. ALL EXISTING UTILITIES SHALL BE TAKEN CARE OF BY THE CONTRACTOR. CONTRACTOR SHALL BE RESPONSIBLE FOR THE OPERATION BY THE CITY. ONCE THE NEW WATER MAIN IS CONNECTED TO THE SYSTEM.
5. EXACT LOCATION AND ELEVATION OF CONNECTION TO EXISTING WATER MAINS SHALL BE DETERMINED BY CONTRACTOR AT TIME OF CONSTRUCTION.
6. ALL NEW PIPELINE/VERTICAL DERIVS TO BE ADJUSTED ACCORDING TO FIELD CONDITIONS BY FIELD ENGINEER.
7. NO TRENCH SHALL BE BACK FILLED UNTIL INSPECTED BY A CITY OF SAN FERNANDO REPRESENTATIVE.
8. ALL TRENCHING AND SHORING SHALL CONFORM TO CAL OSHA STANDARDS.
8. THRUST BLOCKS TO BE LOCATED AT ALL BENDS, TAPPING STEPS, CROSSES AND TEES AS NOTED PER THRUST BLOCK SPECIFICATIONS AND CITY STANDARD PLATES 17, 17A, 18, & 18A. (WHERE APPLICABLE).
10. CONTRACTOR IS RESPONSIBLE TO PROTECT ALL UTILITIES IN PLACE SHOWN AND NOT SHOWN.
11. EXACT RELOCATION AND/OR INSTALLATION OF ALL FIRE HYDRANTS TO BE DETERMINED IN FIELD BY THE ENGINEER. LOCATION SHALL AVOID CONFLICT WITH EXISTING UTILITIES.
12. ALL THRUST BLOCKS MUST BE CURED FOR A MINIMUM OF 48-HRS PRIOR TO ANY PRESSURE TESTING.
13. UNDER NO CIRCUMSTANCES SHALL PRESSURE TESTING BE APPLIED AGAINST EXISTING OR NEW VALVES.
14. NO FINAL CONNECTIONS SHALL BE MADE TO THE EXISTING DISTRIBUTION SYSTEM UNTIL ALL BACTERIAL TESTS HAVE PASSED.
15. CONTRACTOR IS TO LOWER SERVICES WITH LESS THAN 18" OF COVER TO 24" OF COVER.
16. ALL EXISTING STEEL OR PLASTIC WATER SERVICES SHALL BE REPLACED WITH THE SAME SIZE TYPE K COPPER TUBING (1" MINIMUM)
17. VARIES
18. VARIES
19. VARIES
20. VARIES
21. VARIES
22. VARIES
23. VARIES
24. VARIES
25. VARIES
26. VARIES
27. VARIES
28. VARIES
29. VARIES
30. VARIES
31. VARIES
32. VARIES
33. VARIES
34. VARIES
35. VARIES
36. VARIES
37. VARIES
38. VARIES
39. VARIES
40. VARIES
41. VARIES
42. VARIES
43. VARIES
44. VARIES
45. VARIES
46. VARIES
47. VARIES
48. VARIES
49. VARIES
50. VARIES
51. VARIES
52. VARIES
53. VARIES
54. VARIES
55. VARIES
56. VARIES
57. VARIES
58. VARIES
59. VARIES
60. VARIES
61. VARIES
62. VARIES
63. VARIES
64. VARIES
65. VARIES
66. VARIES
67. VARIES
68. VARIES
69. VARIES
70. VARIES
71. VARIES
72. VARIES
73. VARIES
74. VARIES
75. VARIES
76. VARIES
77. VARIES
78. VARIES
79. VARIES
80. VARIES
81. VARIES
82. VARIES
83. VARIES
84. VARIES
85. VARIES
86. VARIES
87. VARIES
88. VARIES
89. VARIES
90. VARIES
91. VARIES
92. VARIES
93. VARIES
94. VARIES
95. VARIES
96. VARIES
97. VARIES
98. VARIES
99. VARIES
100. VARIES
101. VARIES
102. VARIES
103. VARIES
104. VARIES
105. VARIES
106. VARIES
107. VARIES
108. VARIES
109. VARIES
110. VARIES
111. VARIES
112. VARIES
113. VARIES
114. VARIES
115. VARIES
116. VARIES
117. VARIES
118. VARIES
119. VARIES
120. VARIES
121. VARIES
122. VARIES
123. VARIES
124. VARIES
125. VARIES
126. VARIES
127. VARIES
128. VARIES
129. VARIES
130. VARIES
131. VARIES
132. VARIES
133. VARIES
134. VARIES
135. VARIES
136. VARIES
137. VARIES
138. VARIES
139. VARIES
140. VARIES
141. VARIES
142. VARIES
143. VARIES
144. VARIES
145. VARIES
146. VARIES
147. VARIES
148. VARIES
149. VARIES
150. VARIES
151. VARIES
152. VARIES
153. VARIES
154. VARIES
155. VARIES
156. VARIES
157. VARIES
158. VARIES
159. VARIES
160. VARIES
161. VARIES
162. VARIES
163. VARIES
164. VARIES
165. VARIES
166. VARIES
167. VARIES
168. VARIES
169. VARIES
170. VARIES
171. VARIES
172. VARIES
173. VARIES
174. VARIES
175. VARIES
176. VARIES
177. VARIES
178. VARIES
179. VARIES
180. VARIES
181. VARIES
182. VARIES
183. VARIES
184. VARIES
185. VARIES
186. VARIES
187. VARIES
188. VARIES
189. VARIES
190. VARIES
191. VARIES
192. VARIES
193. VARIES
194. VARIES
195. VARIES
196. VARIES
197. VARIES
198. VARIES
199. VARIES
200. VARIES
201. VARIES
202. VARIES
203. VARIES
204. VARIES
205. VARIES
206. VARIES
207. VARIES
208. VARIES
209. VARIES
210. VARIES
211. VARIES
212. VARIES
213. VARIES
214. VARIES
215. VARIES
216. VARIES
217. VARIES
218. VARIES
219. VARIES
220. VARIES
221. VARIES
222. VARIES
223. VARIES
224. VARIES
225. VARIES
226. VARIES
227. VARIES
228. VARIES
229. VARIES
230. VARIES
231. VARIES
232. VARIES
233. VARIES
234. VARIES
235. VARIES
236. VARIES
237. VARIES
238. VARIES
239. VARIES
240. VARIES
241. VARIES
242. VARIES
243. VARIES
244. VARIES
245. VARIES
246. VARIES
247. VARIES
248. VARIES
249. VARIES
250. VARIES
251. VARIES
252. VARIES
253. VARIES
254. VARIES
255. VARIES
256. VARIES
257. VARIES
258. VARIES
259. VARIES
260. VARIES
261. VARIES
262. VARIES
263. VARIES
264. VARIES
265. VARIES
266. VARIES
267. VARIES
268. VARIES
269. VARIES
270. VARIES
271. VARIES
272. VARIES
273. VARIES
274. VARIES
275. VARIES
276. VARIES
277. VARIES
278. VARIES
279. VARIES
280. VARIES
281. VARIES
282. VARIES
283. VARIES
284. VARIES
285. VARIES
286. VARIES
287. VARIES
288. VARIES
289. VARIES
290. VARIES
291. VARIES
292. VARIES
293. VARIES
294. VARIES
295. VARIES
296. VARIES
297. VARIES
298. VARIES
299. VARIES
300. VARIES
301. VARIES
302. VARIES
303. VARIES
304. VARIES
305. VARIES
306. VARIES
307. VARIES
308. VARIES
309. VARIES
310. VARIES
311. VARIES
312. VARIES
313. VARIES
314. VARIES
315. VARIES
316. VARIES
317. VARIES
318. VARIES
319. VARIES
320. VARIES
321. VARIES
322. VARIES
323. VARIES
324. VARIES
325. VARIES
326. VARIES
327. VARIES
328. VARIES
329. VARIES
330. VARIES
331. VARIES
332. VARIES
333. VARIES
334. VARIES
335. VARIES
336. VARIES
337. VARIES
338. VARIES
339. VARIES
340. VARIES
341. VARIES
342. VARIES
343. VARIES
344. VARIES
345. VARIES
346. VARIES
347. VARIES
348. VARIES
349. VARIES
350. VARIES
351. VARIES
352. VARIES
353. VARIES
354. VARIES
355. VARIES
356. VARIES
357. VARIES
358. VARIES
359. VARIES
360. VARIES
361. VARIES
362. VARIES
363. VARIES
364. VARIES
365. VARIES
366. VARIES
367. VARIES
368. VARIES
369. VARIES
370. VARIES
371. VARIES
372. VARIES
373. VARIES
374. VARIES
375. VARIES
376. VARIES
377. VARIES
378. VARIES
379. VARIES
380. VARIES
381. VARIES
382. VARIES
383. VARIES
384. VARIES
385. VARIES
386. VARIES
387. VARIES
388. VARIES
389. VARIES
390. VARIES
391. VARIES
392. VARIES
393. VARIES
394. VARIES
395. VARIES
396. VARIES
397. VARIES
398. VARIES
399. VARIES
400. VARIES
401. VARIES
402. VARIES
403. VARIES
404. VARIES
405. VARIES
406. VARIES
407. VARIES
408. VARIES
409. VARIES
410. VARIES
411. VARIES
412. VARIES
413. VARIES
414. VARIES
415. VARIES
416. VARIES
417. VARIES
418. VARIES
419. VARIES
420. VARIES
421. VARIES
422. VARIES
423. VARIES
424. VARIES
425. VARIES
426. VARIES
427. VARIES
428. VARIES
429. VARIES
430. VARIES
431. VARIES
432. VARIES
433. VARIES
434. VARIES
435. VARIES
436. VARIES
437. VARIES
438. VARIES
439. VARIES
440. VARIES
441. VARIES
442. VARIES
443. VARIES
444. VARIES
445. VARIES
446. VARIES
447. VARIES
448. VARIES
449. VARIES
450. VARIES
451. VARIES
452. VARIES
453. VARIES
454. VARIES
455. VARIES
456. VARIES
457. VARIES
458. VARIES
459. VARIES
460. VARIES
461. VARIES
462. VARIES
463. VARIES
464. VARIES
465. VARIES
466. VARIES
467. VARIES
468. VARIES
469. VARIES
470. VARIES
471. VARIES
472. VARIES
473. VARIES
474. VARIES
475. VARIES
476. VARIES
477. VARIES
478. VARIES
479. VARIES
480. VARIES
481. VARIES
482. VARIES
483. VARIES
484. VARIES
485. VARIES
486. VARIES
487. VARIES
488. VARIES
489. VARIES
490. VARIES
491. VARIES
492. VARIES
493. VARIES
494. VARIES
495. VARIES
496. VARIES
497. VARIES
498. VARIES
499. VARIES
500. VARIES
501. VARIES
502. VARIES
503. VARIES
504. VARIES
505. VARIES
506. VARIES
507. VARIES
508. VARIES
509. VARIES
510. VARIES
511. VARIES
512. VARIES
513. VARIES
514. VARIES
515. VARIES
516. VARIES
517. VARIES
518. VARIES
519. VARIES
520. VARIES
521. VARIES
522. VARIES
523. VARIES
524. VARIES
525. VARIES
526. VARIES
527. VARIES
528. VARIES
529. VARIES
530. VARIES
531. VARIES
532. VARIES
533. VARIES
534. VARIES
535. VARIES
536. VARIES
537. VARIES
538. VARIES
539. VARIES
540. VARIES
541. VARIES
542. VARIES
543. VARIES
544. VARIES
545. VARIES
546. VARIES
547. VARIES
548. VARIES
549. VARIES
550. VARIES
551. VARIES
552. VARIES
553. VARIES
554. VARIES
555. VARIES
556. VARIES
557. VARIES
558. VARIES
559. VARIES
560. VARIES
561. VARIES
562. VARIES
563. VARIES
564. VARIES
565. VARIES
566. VARIES
567. VARIES
568. VARIES
569. VARIES
570. VARIES
571. VARIES
572. VARIES
573. VARIES
574. VARIES
575. VARIES
576. VARIES
577. VARIES
578. VARIES
579. VARIES
580. VARIES
581. VARIES
582. VARIES
583. VARIES
584. VARIES
585. VARIES
586. VARIES
587. VARIES
588. VARIES
589. VARIES
590. VARIES
591. VARIES
592. VARIES
593. VARIES
594. VARIES
595. VARIES
596. VARIES
597. VARIES
598. VARIES
599. VARIES
600. VARIES
601. VARIES
602. VARIES
603. VARIES
604. VARIES
605. VARIES
606. VARIES
607. VARIES
608. VARIES
609. VARIES
610. VARIES
611. VARIES
612. VARIES
613. VARIES
614. VARIES
615. VARIES
616. VARIES
617. VARIES
618. VARIES
619. VARIES
620. VARIES
621. VARIES
622. VARIES
623. VARIES
624. VARIES
625. VARIES
626. VARIES
627. VARIES
628. VARIES
629. VARIES
630. VARIES
631. VARIES
632. VARIES
633. VARIES
634. VARIES
635. VARIES
636. VARIES
637. VARIES
638. VARIES
639. VARIES
640. VARIES
641. VARIES
642. VARIES
643. VARIES
644. VARIES
645. VARIES
646. VARIES
647. VARIES
648. VARIES
649. VARIES
650. VARIES
651. VARIES
652. VARIES
653. VARIES
654. VARIES
655. VARIES
656. VARIES
657. VARIES
658. VARIES
659. VARIES
660. VARIES
661. VARIES
662. VARIES
663. VARIES
664. VARIES
665. VARIES
666. VARIES
667. VARIES
668. VARIES
669. VARIES
670. VARIES
671. VARIES
672. VARIES
673. VARIES
674. VARIES
675. VARIES
676. VARIES
677. VARIES
678. VARIES
679. VARIES
680. VARIES
681. VARIES
682. VARIES
683. VARIES
684. VARIES
685. VARIES
686. VARIES
687. VARIES
688. VARIES
689. VARIES
690. VARIES
691. VARIES
692. VARIES
693. VARIES
694. VARIES
695. VARIES
696. VARIES
697. VARIES
698. VARIES
699. VARIES
700. VARIES
701. VARIES
702. VARIES
703. VARIES
704. VARIES
705. VARIES
706. VARIES
707. VARIES
708. VARIES
709. VARIES
710. VARIES
711. VARIES
712. VARIES
713. VARIES
714. VARIES
715. VARIES
716. VARIES
717. VARIES
718. VARIES
719. VARIES
720. VARIES
721. VARIES
722. VARIES
723. VARIES
724. VARIES
725. VARIES
726. VARIES
727. VARIES
728. VARIES
729. VARIES
730. VARIES
731. VARIES
732. VARIES
733. VARIES
734. VARIES
735. VARIES
736. VARIES
737. VARIES
738. VARIES
739. VARIES
740. VARIES
741. VARIES
742. VARIES
743. VARIES
744. VARIES
745. VARIES
746. VARIES
747. VARIES
748. VARIES
749. VARIES
750. VARIES
751. VARIES
752. VARIES
753. VARIES
754. VARIES
755. VARIES
756. VARIES
757. VARIES
758. VARIES
759. VARIES
760. VARIES
761. VARIES
762. VARIES
763. VARIES
764. VARIES
765. VARIES
766. VARIES
767. VARIES
768. VARIES
769. VARIES
770. VARIES
771. VARIES
772. VARIES
773. VARIES
774. VARIES
775. VARIES
776. VARIES
777. VARIES
778. VARIES
779. VARIES
780. VARIES
781. VARIES
782. VARIES
783. VARIES
- 78

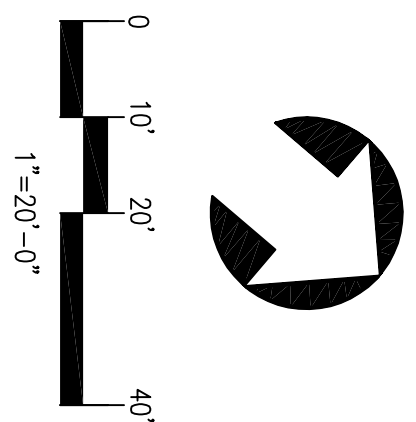
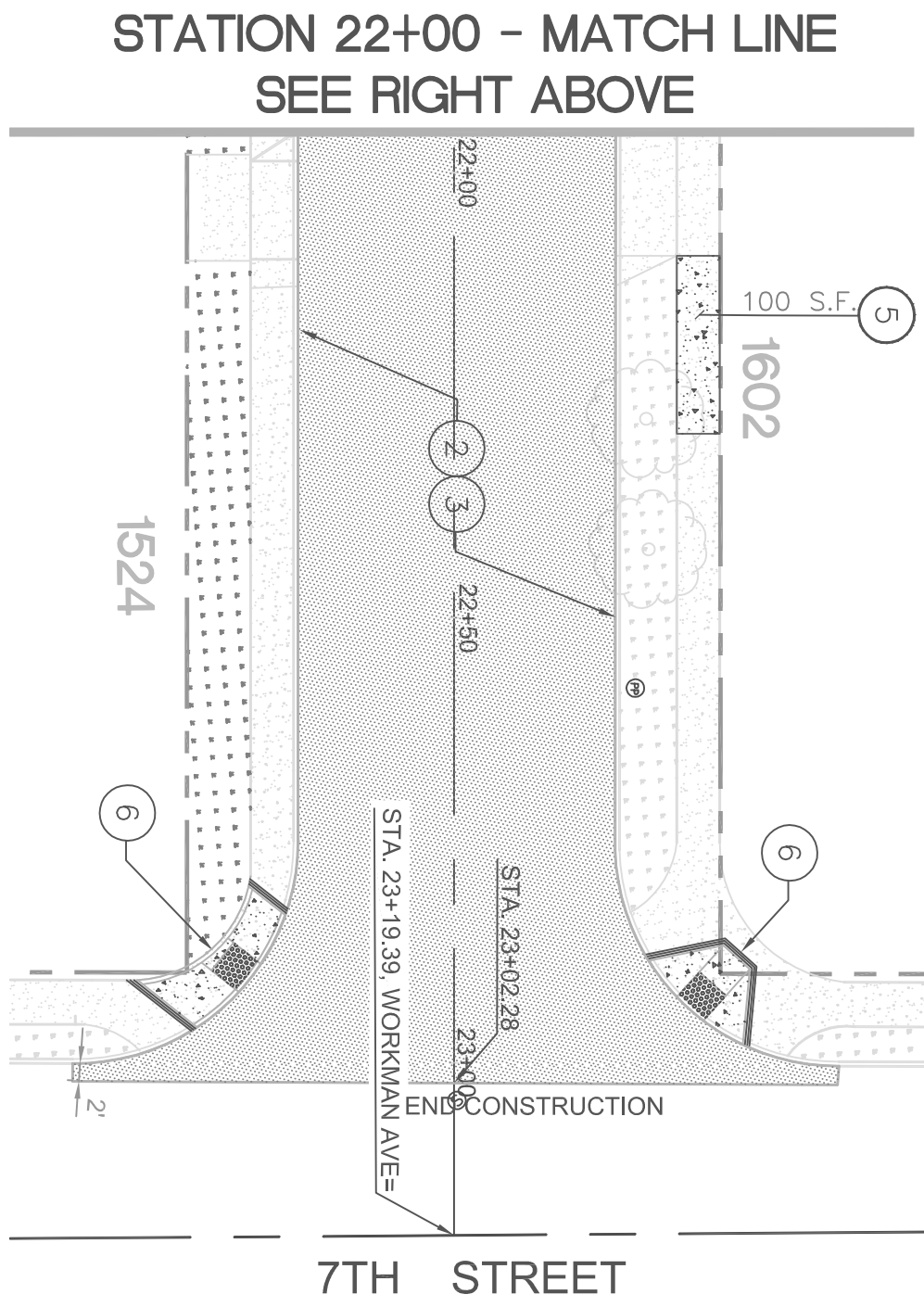
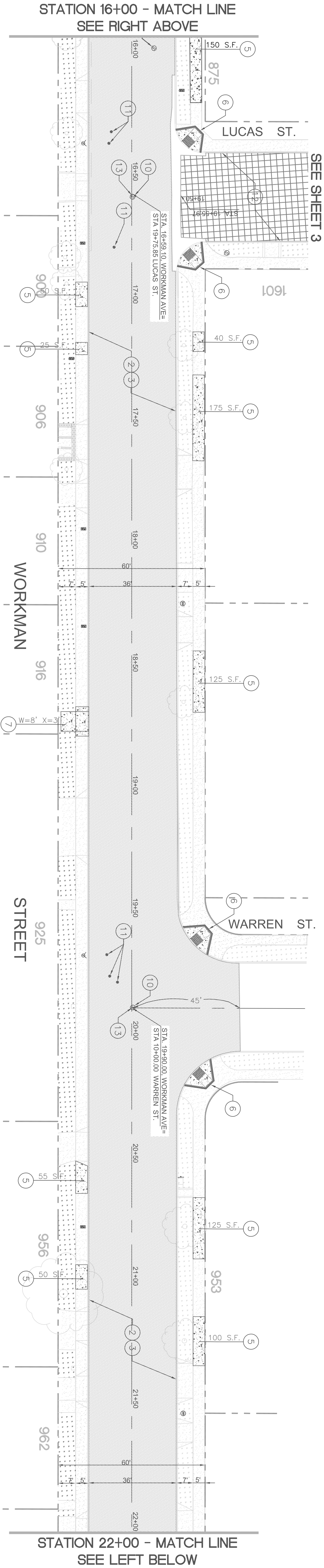
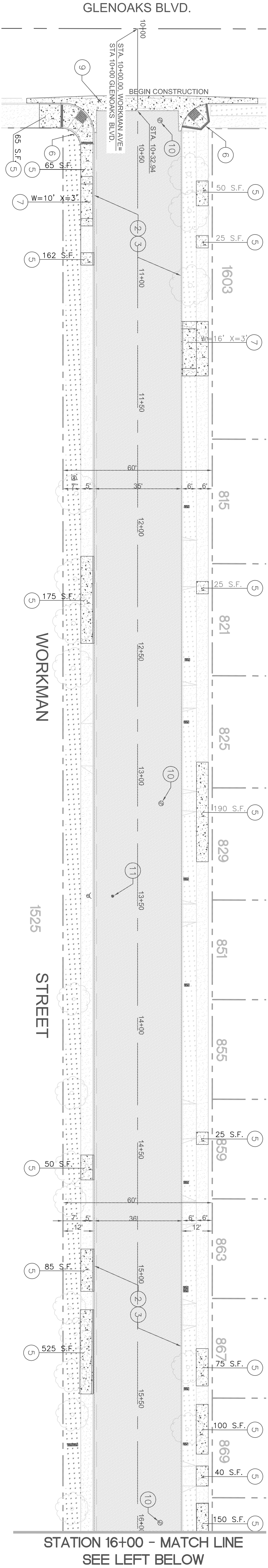

- LEGENDS**
- W — WATER LINE
 - ⊙ — WATER VALVE
 - ⊙ — WATER HYDRANT
 - ⊙ — SEWER MANHOLE
 - ⊙ — PROPOSED TREE
 - ⊙ — STREET SIGN
 - ⊙ — WATER METER BOX
 - ⊙ — GAS VALVE
 - ⊙ — GAS METER
 - ⊙ — GAS LINE
 - ⊙ — PROPOSED COLD MILL AND OVERLAY
 - ⊙ — SLURRY SEAL
 - ⊙ — R/W LINE
 - ⊙ — STORMDRAIN MANHOLE
- CONSTRUCTION NOTES**
- PROTECT IN PLACE.
 - COLD MILL 1.5-INCH THICK EXISTING PAVEMENT.
 - CONSTRUCT 1.5-INCH THICK PAVEMENT ARHM-GG-C (PG 64-16).
 - CONSTRUCT SPEED HUMP PER DETAIL ON SHEET 1.
 - REMOVE EXISTING AND CONSTRUCT 4-INCH THICK PCC SIDEWALK PER SPPWC STD. PLAN 113-2.
 - REMOVE EXISTING RAMP/SIDEWALK AND CONSTRUCT PCC CURB RAMP PER SPPWC STD. PLAN 111-5 WITH TRUNCATED DOKES.
 - REMOVE EXISTING AND CONSTRUCT 4-INCH THICK PCC DRIVEWAY APPROACHES PER SPPWC STD. PLAN 110-2.
 - REMOVE, DISPOSE AND CONSTRUCT PCC 8-INCH CURB AND 24-INCH CUTTER PER SPPWC STD. PLAN 120-2.
 - CONSTRUCT PCC LONGITUDINAL CROSS GUTTER PER SPPWC STD. PLAN 122-2.
 - ADJUST MANHOLE FRAME AND COVER TO GRADE PER SPPWC STD. PLAN 205-2.
 - ADJUST EXISTING WATER/GAS VALVE GAN AND LID OR WATER/GAS METER BOX TO GRADE.
 - CONSTRUCT SLURRY SEAL TYPE 2.
 - RE-ESTABLISH EXISTING STREET MONUMENTATION.

811 Know what's below. Call before you dig.

R E V I S I O N S				BENCH MARK:
NUMBER	DATE	INITIALS	APPROV.	

SAN FERNANDO PUBLIC WORKS DEPARTMENT

YING KWAN, P.E., CONSULTING CITY ENGINEER, RCE 42418

DATE

CH2M HILL CONSULTING CIVIL ENGINEERS

PLANS PREPARED UNDER THE SUPERVISION OF: JOAQUIN CERVANTES, JR., P.E.

DATE: JC 4/20/2017

DESIGN BY: JC 4/20/2017

DRAWN BY: DC 4/20/2017

CHECKED BY: CA 5/30/2017

2018-2019 ANNUAL STREET RESURFACING PROJECT

WORKMAN STREET

FROM GLENOAKS BLVD TO 7TH STREET

CITY OF SAN FERNANDO

PLAN NO. **P-726**

SHEET **2** OF 22

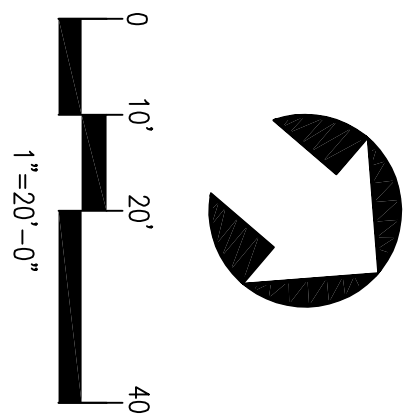
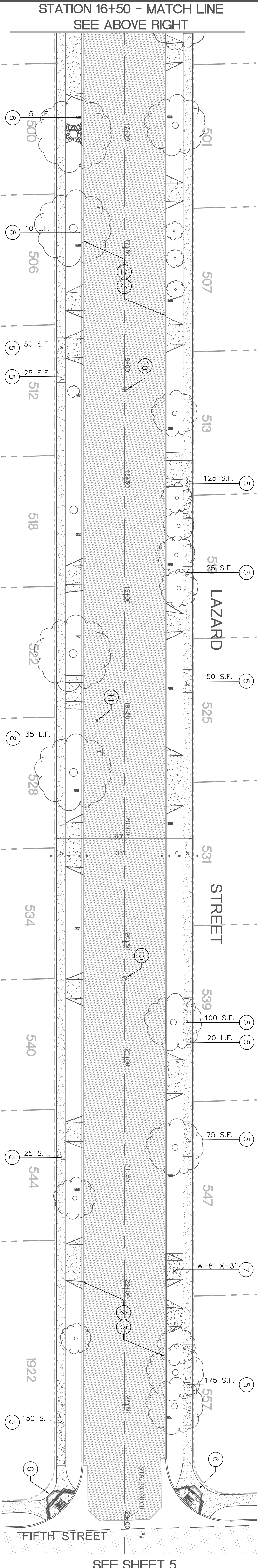
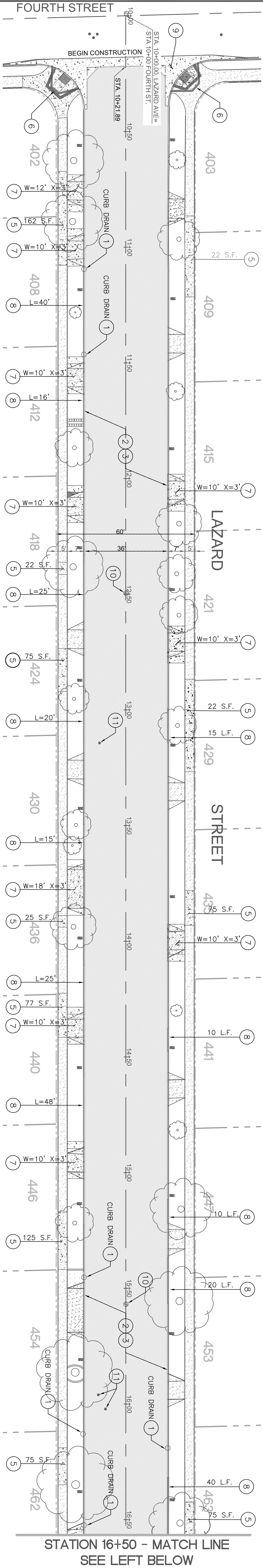

- LEGENDS**

W	WATER LINE
⊗	WATER VALVE
⊙	WATER HYDRANT
⊖	SEWER MANHOLE
⊕	STREET SIGN
○	PROPOSED TREE
W	WATER METER BOX
⊙	GAS VALVE
⊖	GAS METER
G	GAS LINE
.....	PROPOSED PCC
.....	PROPOSED COLD MILL AND OVERLAY
.....	SLURRY SEAL
.....	R/W LINE
Ⓢ	STORMDRAIN MANHOLE
- CONSTRUCTION NOTES**

 - PROTECT IN PLACE.
 - COLD MILL, 1.5-INCH THICK EXISTING PAVEMENT.
 - CONSTRUCT 1.5-INCH THICK PAVEMENT ARHW-GG-C (PG 64-16).
 - CONSTRUCT SPEED HUMP PER DETAIL ON SHEET 1.
 - REMOVE EXISTING AND CONSTRUCT 4-INCH THICK PCC SIDEWALK PER SPWC STD. PLAN 113-2.
 - REMOVE EXISTING RAMP/SIDEWALK AND CONSTRUCT PCC CURB RAMP PER SPWC STD. PLAN 111-5 WITH TRIANGULAR DOWNS.
 - REMOVE EXISTING AND CONSTRUCT 4-INCH THICK PCC DRIVEWAY APPROACHES PER SPWC STD. PLAN 110-2.
 - REMOVE, DISPOSE AND CONSTRUCT PCC 8-INCH CURB AND 24-INCH GUTTER PER SPWC STD. PLAN 120-2.
 - CONSTRUCT PCC LONGITUDINAL CROSS GUTTER PER SPWC STD. PLAN 122-2.
 - ADJUST MANHOLE FRAME AND COVER TO GRADE PER SPWC STD. PLAN 205-2.
 - ADJUST EXISTING WATER/GAS VALVE CAV AND LID OR WATER/GAS METER BOX TO GRADE.
 - CONSTRUCT SLURRY SEAL TYPE 2.
 - RE-ESTABLISH EXISTING STREET MONUMENTATION.



Know what's below.
Call before you dig.

NUMBER	DATE	INITIALS	APPROV.

BENCH MARK:



SAN FERNANDO
PUBLIC WORKS DEPARTMENT

YING KWAN, P.E., CONSULTING CITY ENGINEER, RCE 42418

DATE



CH2M HILL
CONSULTING CIVIL ENGINEERS

PLANS PREPARED UNDER THE SUPERVISION OF:
JOAQUIN CERVAANTES, JR., P.E.

DATE:
JC 4/20/2017
DC 4/20/2017
CA 5/30/2017

2018-2019 ANNUAL STREET RESURFACING PROJECT

LAZARD STREET
FROM FOURTH STREET TO GLENDAKS BLVD

PLAN NO.
P-726

SHEET **4** OF 22

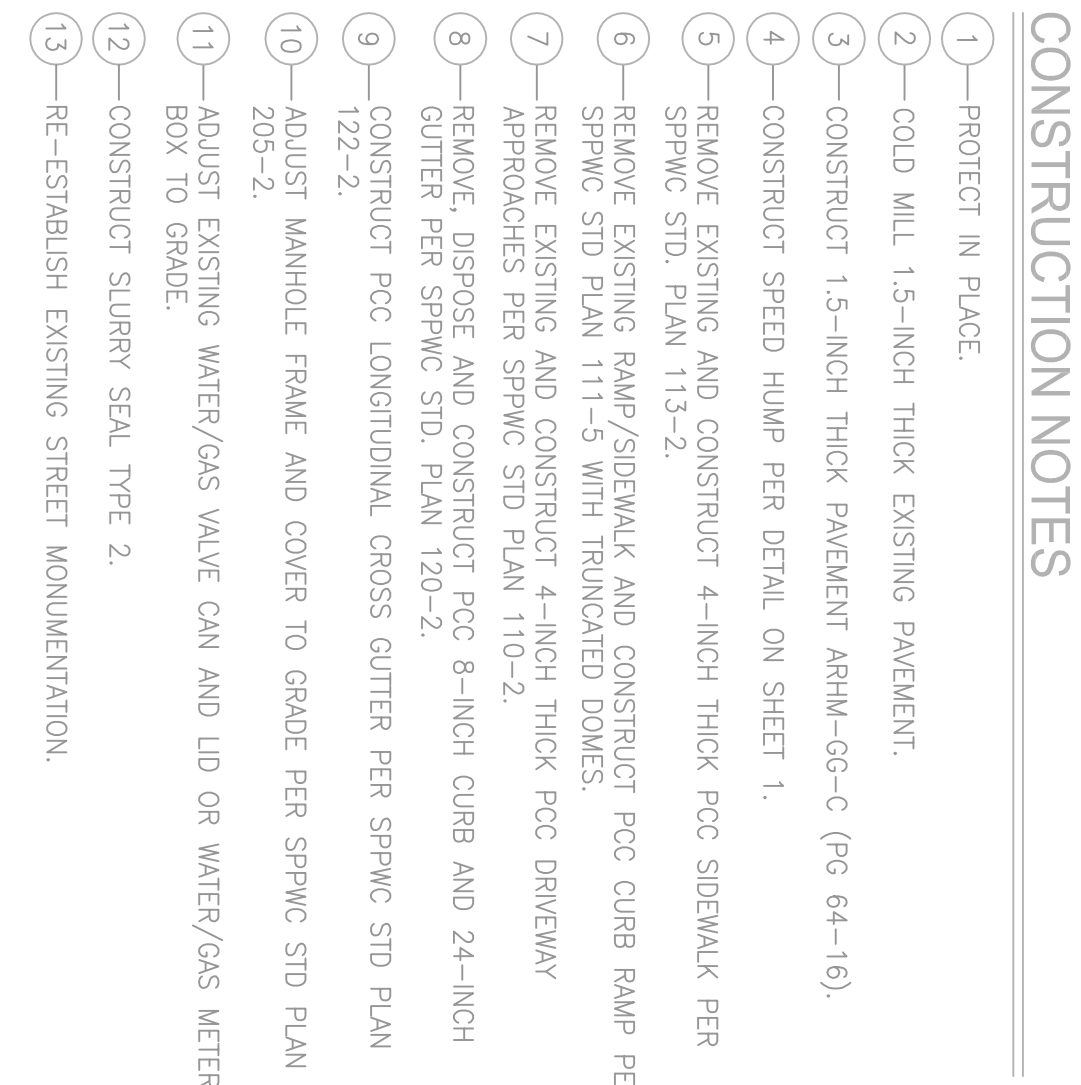

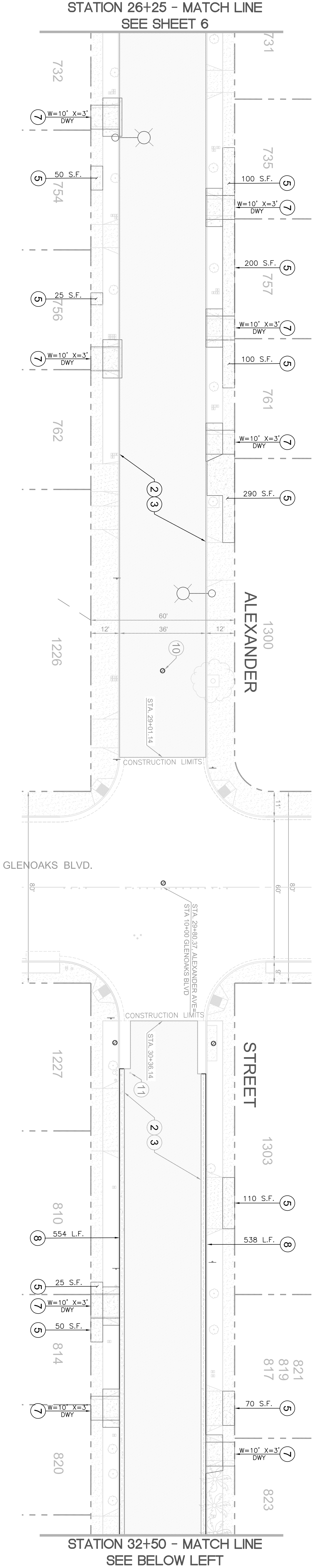

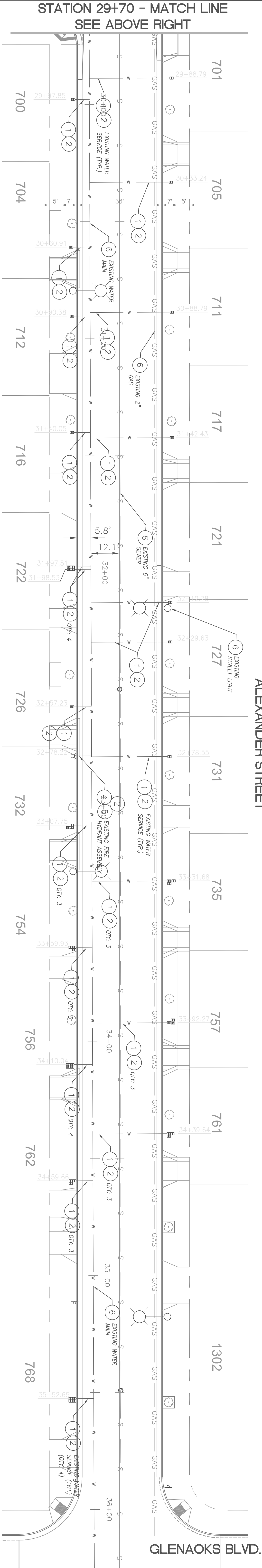
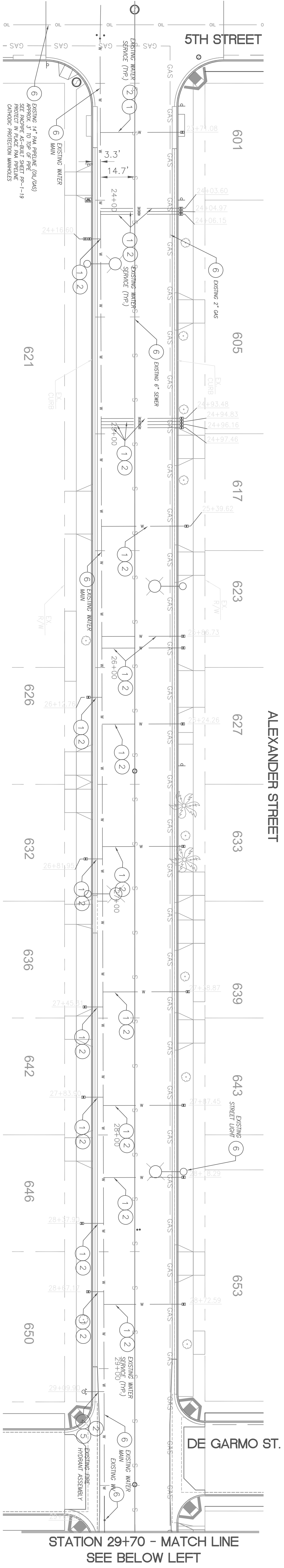



WATER CONSTRUCTION NOTES:

- 1 REMOVE EXISTING WATER SERVICE & INSTALL 1" WATER SERVICE & METER BOX PER CITY WATER CONSTRUCTION STANDARDS PLATE NO. 19 AND PROJECT SPECIFICATIONS. 56" MINIMUM COVER.
- 2 REPLACE AC PAVEMENT, BASE & BACKFILL PER CITY WATER CONSTRUCTION STANDARDS PLATE NO. 3 AND PROJECT SPECIFICATIONS.
- 3 REMOVE EXISTING AND INSTALL 6" RESILIENT WEDGE GATE VALVE PER CITY WATER CONSTRUCTION STANDARDS PLATE NO. 8 AND PROJECT SPECIFICATIONS.
- 4 REMOVE EXISTING & INSTALL FIRE HYDRANT ASSEMBLY PER CITY WATER CONSTRUCTION STANDARDS PLATE NO. 11 AND PROJECT SPECIFICATIONS.
- 5 INSTALL THRUST BLOCK PER CITY WATER CONSTRUCTION STANDARDS PLATE NO. 17, 17A, 18 AND 18A.
- 6 PROTECT IN PLACE

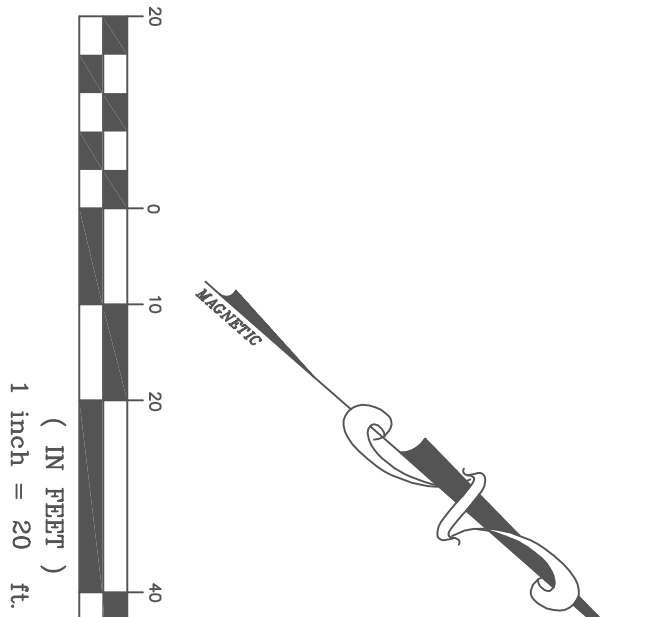
WATER SERVICE LATERAL REPLACEMENT





Know what's below.
Call before you dig.

R E V I S I O N S		
NUMBER	DATE	INITIALS

BENCH MARK:



PUBLIC WORKS DEPARTMENT

YING KWAN P.E., CONSULTING CITY ENGINEER, RCE 42418

DATE

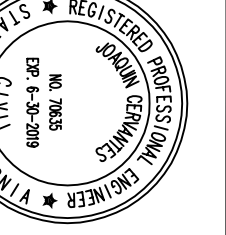

CONSULTING CIVIL ENGINEERS

19600 JAMES RD., SUITE B13
VAN NUYS, CA 91411
(818) 997-9573 / (818) 997-9574 FAX

PLANS PREPARED UNDER THE SUPERVISION OF:

DESIGN BY: JC 4/20/2017
DRAWN BY: DC 4/20/2017
CHECKED BY: CA 5/20/2017

2018-2019 ANNUAL STREET RESURFACING PROJECT

ALEXANDER STREET
FROM FIFTH STREET TO GLENAOKS BOULEVARD

CITY OF SAN FERNANDO

PLAN NO.
P-726

SHEET 8 OF 22

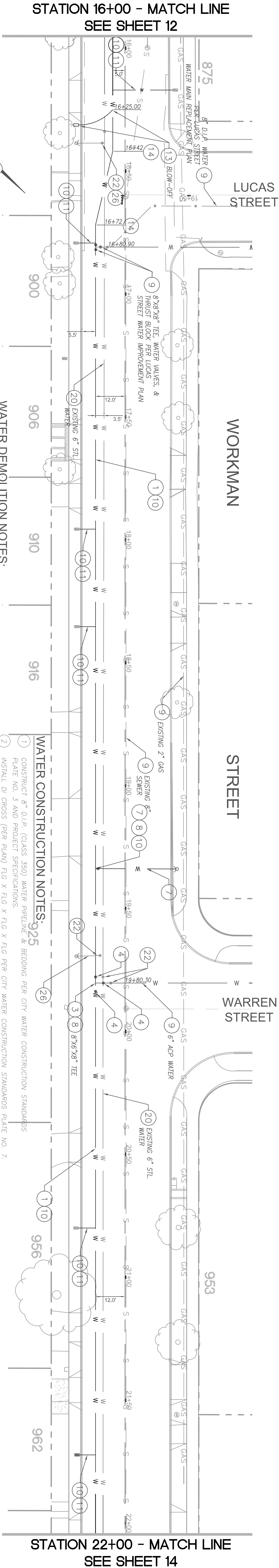
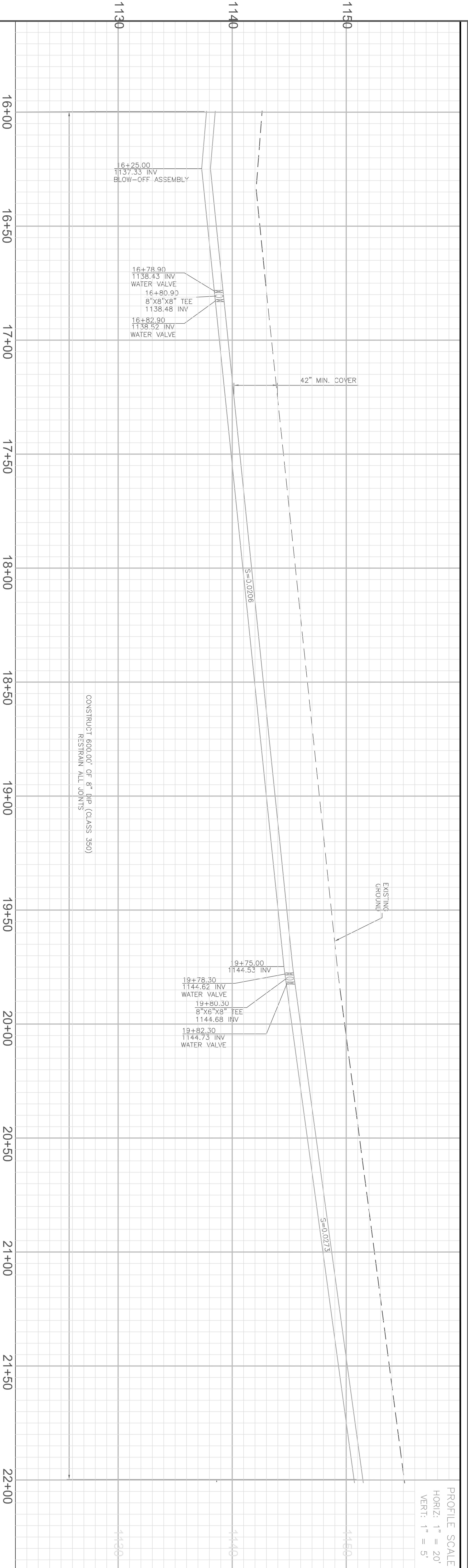

WATER DEMOLITION NOTES:

- 20 ABANDON EXISTING WATERLINE (SIZE/TYPE PER PLAN) AND INTERFERING SERVICES PER CITY WATER CONSTRUCTION STANDARDS & PROJECT SPECIFICATIONS.
- 21 ABANDON EXISTING 8"x8"x8" DI TEE PER CITY WATER CONSTRUCTION STANDARDS & PROJECT SPECIFICATIONS.
- 22 ABANDON EXISTING 6" GATE VALVE PER CITY WATER CONSTRUCTION STANDARDS & PROJECT SPECIFICATIONS.
- 23 ABANDON EXISTING 8"x6"x6" DI TEE PER CITY WATER CONSTRUCTION STANDARDS & PROJECT SPECIFICATIONS.
- 24 REMOVE EXISTING DI CROSS PER CITY WATER CONSTRUCTION STANDARDS & PROJECT SPECIFICATIONS.
- 25 ABANDON EXISTING 8" GATE VALVE PER CITY WATER CONSTRUCTION STANDARDS & PROJECT SPECIFICATIONS.
- 26 REMOVE EXISTING HYDRANT AND SALVAGE TO THE CITY

WATER CONSTRUCTION NOTES: 925

- 1 CONSTRUCT 8" D.I.P. (CLASS 350) WATER PRELINE & BEDDING PER CITY WATER CONSTRUCTION STANDARDS
- 2 INSTALL DI CROSS (PER PLAN) FLG X FLG X FLG X FLG PER CITY WATER CONSTRUCTION STANDARDS PLATE NO. 7.
- 3 INSTALL 8" GATE VALVE FLG X FLG X FLG PER CITY WATER CONSTRUCTION STANDARDS PLATE NO. 7.
- 4 INSTALL 8"x6"x6" DI FLG X FLG X FLG TEE PER CITY WATER CONSTRUCTION STANDARDS PLATE NO. 7.
- 5 INSTALL 6" GATE VALVE FLG X MU PER CITY WATER CONSTRUCTION STANDARDS PLATE NO. 29A & PLATE NO. 8.
- 6 CONSTRUCT FIRE HYDRANT LINE AND ASSEMBLY AND CONNECT TO MAIN PER CITY WATER CONSTRUCTION STANDARDS AND SPECIFICATIONS PLATE NO. 11.
- 7 INSTALL THRUST BLOCK PER CITY STANDARDS AND SPECIFICATIONS PLATE NO. 17, 17A, 18 AND 18A.
- 8 PROTECT IN PLACE
- 9 REPLACE AC PAVEMENT, BASE & BACKFILL PER CITY WATER CONSTRUCTION STANDARDS PLATE NO. 3 & PROJECT SPECIFICATIONS.
- 10 REMOVE EXISTING WATER SERVICE & INSTALL 1" WATER SERVICE AND WATER BOX PER CITY WATER CONSTRUCTION STANDARDS PLATE NO. 19 AND PROJECT SPECIFICATIONS. 36" MINIMUM COVER
- 11 INSTALL AIR AND VACUUM RELEASE VALVE ASSEMBLY PER CITY WATER CONSTRUCTION STANDARDS PLATE NO. 14.
- 12 INSTALL BLOW-OFF ASSEMBLY PER CITY WATER CONSTRUCTION STANDARDS PLATE NO. 12.
- 13 CONSTRUCT 8" 22 1/2" DI MU X MU BEND AND RESTRAINED JOINT PER SAN FERNANDO WATER CONSTRUCTION STANDARDS.
- 14

WATER MAIN REPLACEMENT

811

Know what's below.
Call before you dig.

REVISIONS

NUMBER	DATE	INITIALS	APPRO.

BENCH MARK:

PUBLIC WORKS DEPARTMENT

YING KWAN, P.E., CONSULTING CITY ENGINEER, RCE 42418

DATE

REGISTERED PROFESSIONAL ENGINEER
NO. 9002
EXPIRATION DATE 12/31/2020
CIVIL

PLANS PREPARED UNDER THE SUPERVISION OF:

DATE:

DESIGN BY: JC 4/20/2017

DRAWN BY: DC 4/20/2017

CHECKED BY: CA 5/20/2017

CONSULTING CIVIL ENGINEERS
15800 AVANT RD., SUITE B13
IRVINE, CA 92618
(949) 261-8414 FAX

2018-2019 ANNUAL STREET RESURFACING PROJECT

PLAN NO.

WORKMAN STREET
FROM GLENOAKS BLVD TO 7TH STREET

P-726

CITY OF SAN FERNANDO

SHEET 13 OF 22

PROFILE SCALE
HORIZ: 1" = 20'
VERT: 1" = 4'

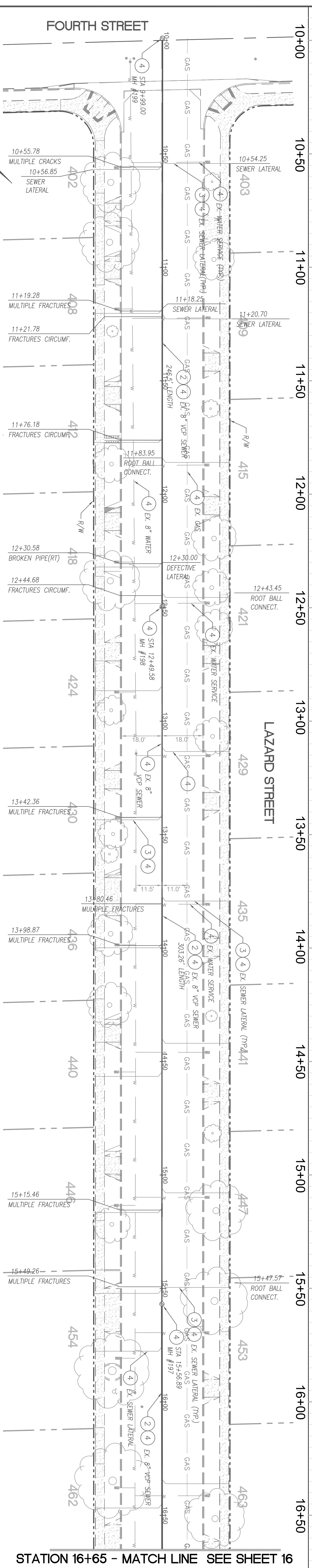
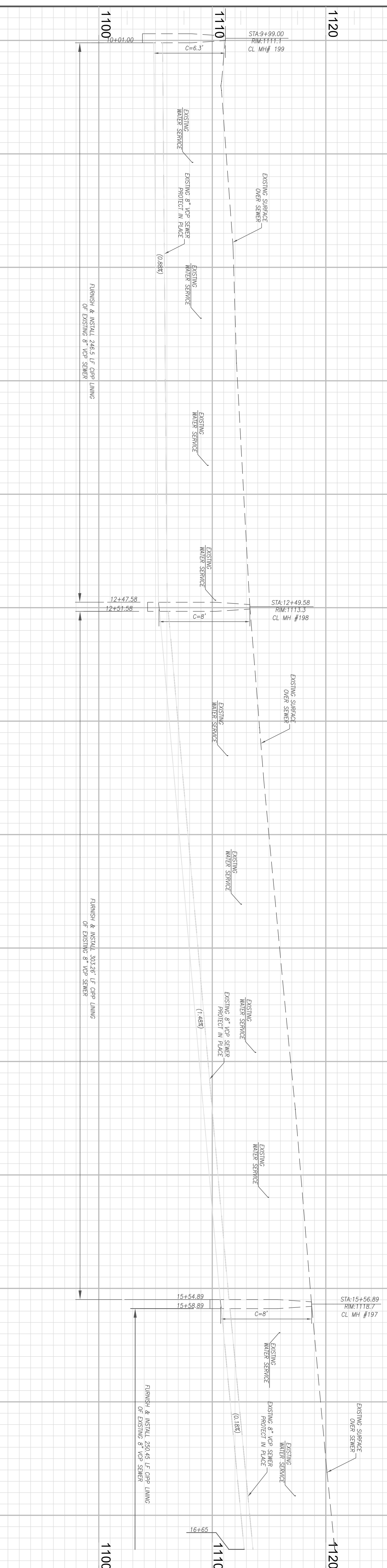

CONSTRUCTION NOTES

1. FURNISH & INSTALL PIPE SLEEVE AND EXISTING 8" TOP SEWER MAIN PER PROJECT SPECIFICATIONS
2. FURNISH & INSTALL CURP LINING OF EXISTING 8" VCP OR CONCRETE SEWER MAIN PER PROJECT SPECIFICATIONS
3. REINSTATE EXISTING 6" V.C.P. HOUSE CONNECTION PER PROJECT SPECIFICATIONS
4. PROTECT EXISTING IN PLACE

SEWER IMPROVEMENTS

[illegible]

THE CITY OF
SAN FERNANDO
PUBLIC WORKS DEPARTMENT

YING KWAN, P.E., CONSULTING CITY ENGINEER, RCE 42418

DATE _____

PLANS PREPARED UNDER THE SUPERVISION OF: JACQUIN CERVANTES, JR., P.E.

Plans Prepared By: _____

DATE: _____

CHECKED BY: _____

DESIGN BY: JC 4/20/2017

DRAWN BY: DC 4/20/2017

CA 5/30/2017





JCE
Engineering, Inc.
Land Development

CONSULTING CIVIL ENGINEERS

10860 BAYVIEW RD., SUITE B113
VICTORIA, B.C., V8N 6P8
(250) 367-0633 (toll free) 877-874-745X

2018-2019 ANNUAL STREET RESURFACING PROJECT	PLAN NO.
LAZARD STREET FROM FOURTH STREET TO GLENOAKS BOULEVARD	P-726
CITY OF SAN FERNANDO	SHEET 15 OF 22

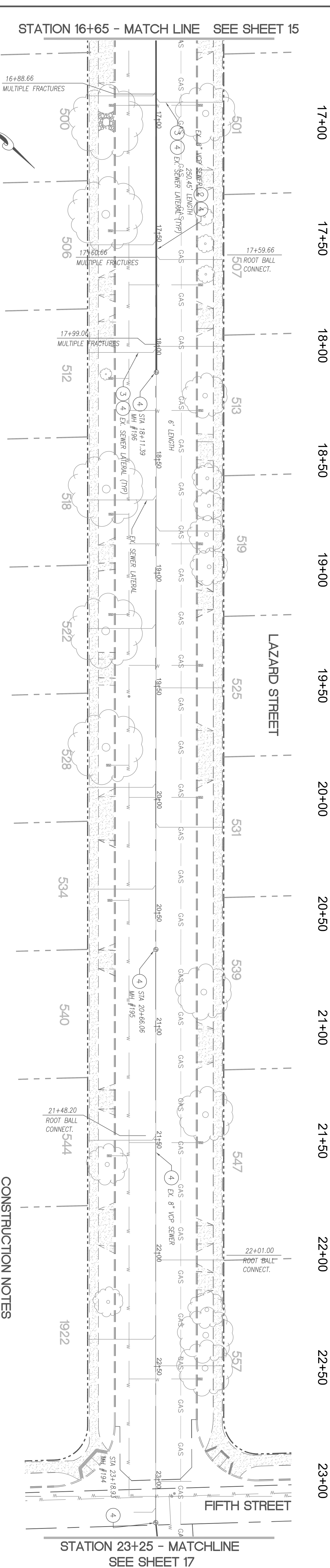
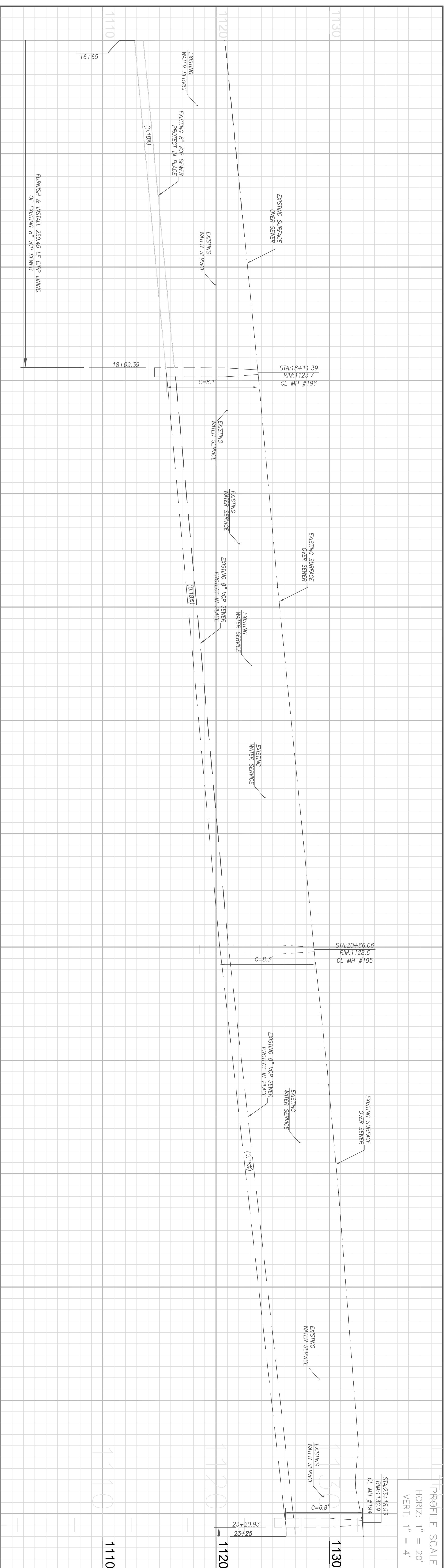

CONSTRUCTION NOTES

1. FURNISH & INSTALL PIPE SLEEVE INTO EXISTING 8" VCP SEWER MAIN PER PROJECT SPECIFICATIONS
2. FURNISH & INSTALL DIPP LINING OF EXISTING 8" VCP OR CONCRETE SEWER MAIN PER PROJECT SPECIFICATIONS
3. REINSTATE EXISTING 6" "C.P. HOUSE CONNECTION PER PROJECT SPECIFICATIONS
4. PROTECT EXISTING IN PLACE

SEWER IMPROVEMENTS

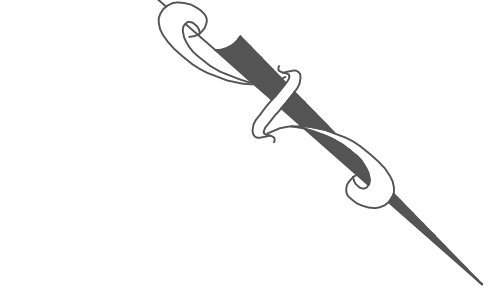
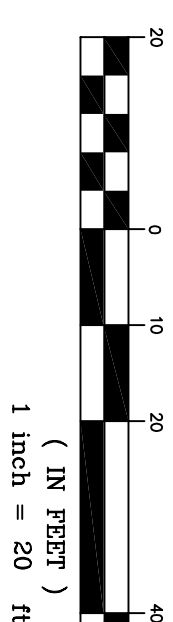

REVISIONS				BENCH MARK:	
NUMBER	DATE	INITIALS	APPROV'D.		



Know what's below.
Call before you dig.

THE CITY OF
SAN FERNANDO
PUBLIC WORKS DEPARTMENT

YING KWAN P.E., CONSULTING CITY ENGINEER, RCE 42418

DATE _____



PLANS PREPARED UNDER THE SUPERVISION OF: _____ DATE: _____

J. B. CERVANTES, JR., P.E.

Plans Prepared By:



CER CONSULTING CIVIL ENGINEERS
18400 MARIN RD., SUITE B13
VAN NUYS, CA 91411
(818) 967-9675 / (818) 967-9674 FAX

DESIGN BY: JC 4/20/2017
DRAWN BY: DC 4/20/2017
CHECKED BY: CA 5/20/2017

2018-2019 ANNUAL STREET RESURFACING PROJECT

LAZARD STREET

FROM FOURTH STREET TO GLENOAKS BOULEVARD

CITY OF SAN FERNANDO

PLAN NO.

P-726

SHEET 16 OF 22

PROFILE SCALE
HORZ.: 1" = 20'
VERT: 1" = 4'

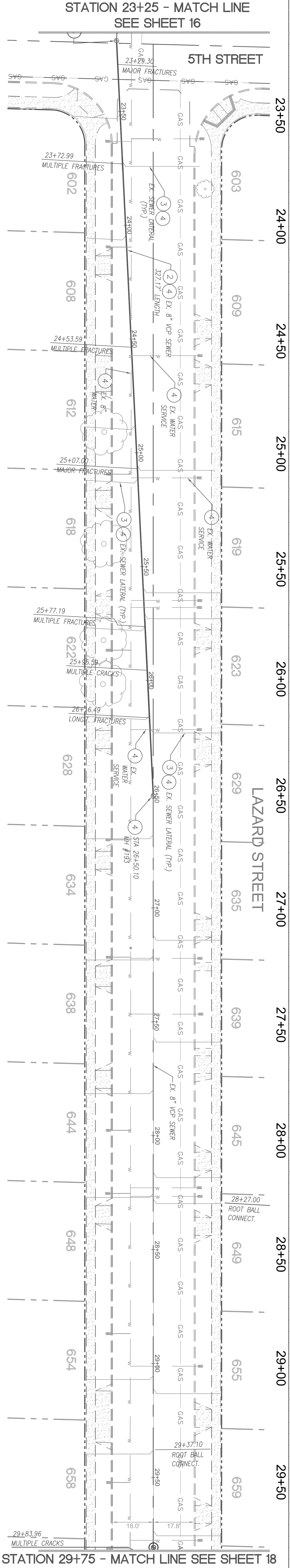
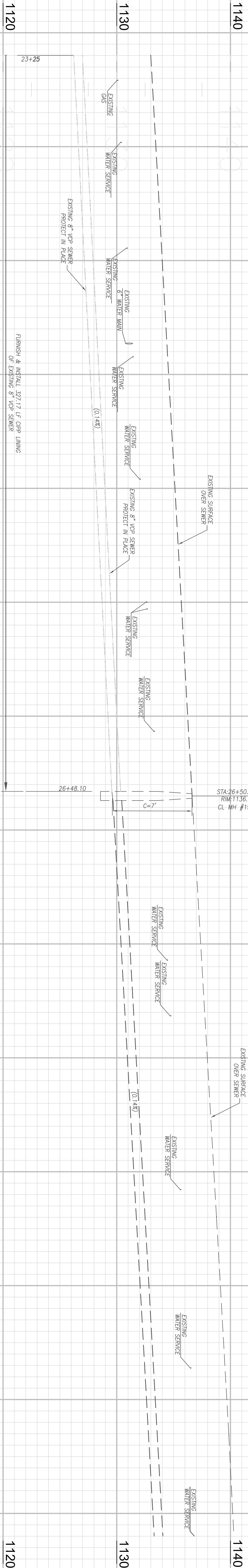

- CONSTRUCTION NOTES**
- 1 FURNISH & INSTALL PRE SLEEVE INTO EXISTING 8" VCP SEWER MAIN PER PROJECT SPECIFICATIONS
 - 2 FURNISH & INSTALL CIPP LINING OF EXISTING 8" VCP OR CONCRETE SEWER MAIN PER PROJECT SPECIFICATIONS
 - 3 REINSTATE EXISTING 6" VCP HOUSE CONNECTION PER PROJECT SPECIFICATIONS
 - 4 PROTECT EXISTING IN PLACE

SEWER IMPROVEMENTS

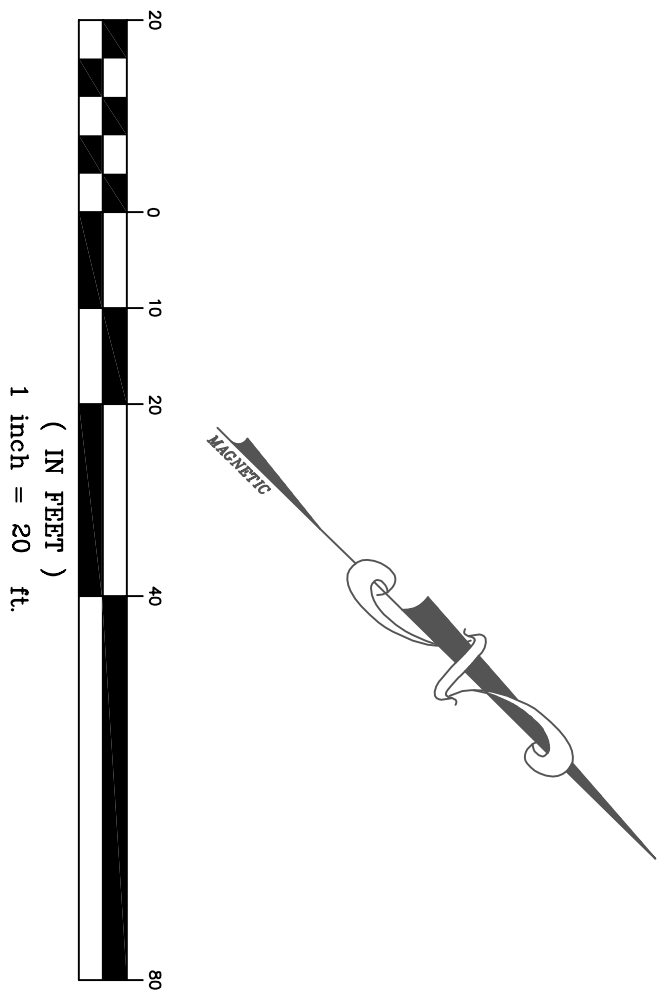

811

Know what's below.
Call before you dig.

NUMBER	DATE	INITIALS	APP'D.

REVISIONS

BENCH MARK:

THE CITY OF

SAN FERNANDO

PUBLIC WORKS DEPARTMENT

YING KHAU, P.E., CONSULTING CITY ENGINEER, REG. 42418

DATE

PLANS PREPARED UNDER THE SUPERVISION OF:

DATE:

DESIGN BY: JC 4/23/2017

CHECKED BY: CA 5/29/2017

2018-2019 ANNUAL STREET RESURFACING PROJECT

LAZARD STREET
FROM FOURTH STREET TO GLENOAKS BOULEVARD

PLAN NO.
P-726

SHEET 17 OF 22

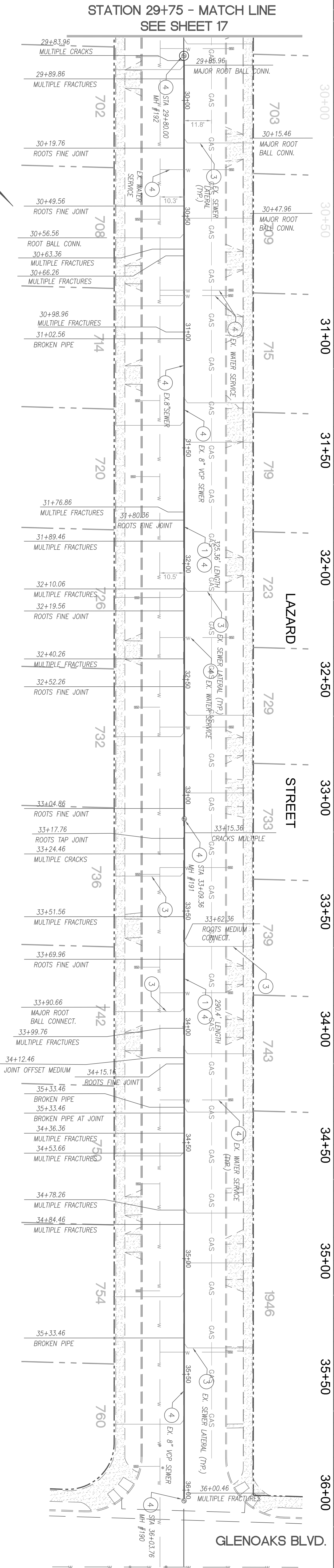
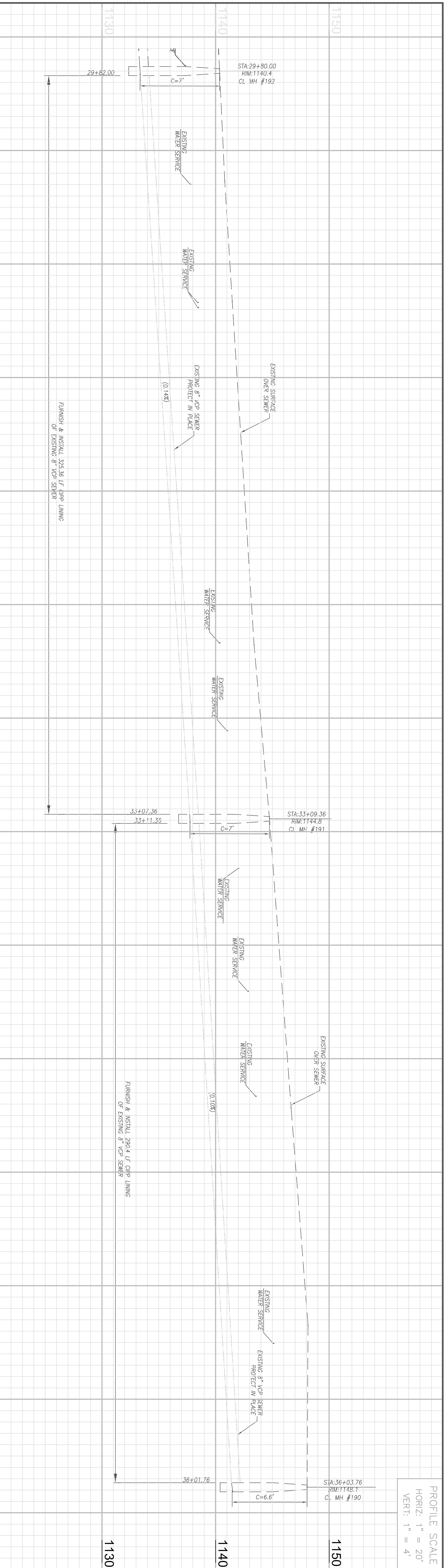

- ## CONSTRUCTION NOTES
1. FURNISH & INSTALL PIPE SLEEVE INTO EXISTING 8" VCP SEWER MAIN PER PROJECT SPECIFICATIONS
 2. FURNISH & INSTALL CIPP LINING OF EXISTING 8" VCP OR CONCRETE SEWER MAIN PER PROJECT SPECIFICATIONS
 3. REINSTATE EXISTING 6" V.C.P. HOUSE CONNECTION PER PROJECT SPECIFICATIONS
 4. PROTECT EXISTING IN PLACE

SEWER IMPROVEMENTS

2018-2019 ANNUAL STREET RESURFACING PROJECT

FROM FOURTH STREET TO GLENOAKS BOULEVARD

CITY OF SAN FERNANDO

SHEET 18 OF 22

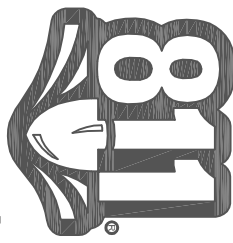

**Know what's below.
Call before you dig.**

[illegible]

BENCH MARK:

 THE CITY OF
SAN FERNANDO
PUBLIC WORKS DEPARTMENT

YING KWAN, P.E., CONSULTING CITY ENGINEER, RCE 42418

DATE _____



PLANS PREPARED UNDER THE
JOAQUIN CERVANTES, JR., P.E.



DESIGN BY:	JC	4/20/2017
DRAWN BY:	DC	4/20/2017
CHECKED BY:	CA	5/30/2017

CONSULTING CIVIL ENGINEER
18800 AAMAR RD., SUITE B13
WALNUT, CA. 91789
(626) 667-8675 / (626) 667-8674 FAX

DRAWN BY:	DC	4/20/2017
CHECKED BY:	CA	5/30/2017

PLAN NO

P-726

SHEET 18 OF 22

PROFILE SCALE
HORZ: 1" = 20'
VERT: 1" = 4'

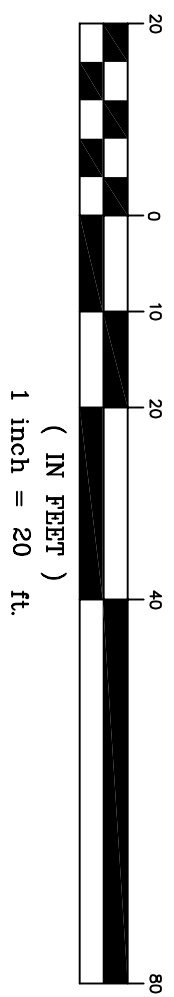
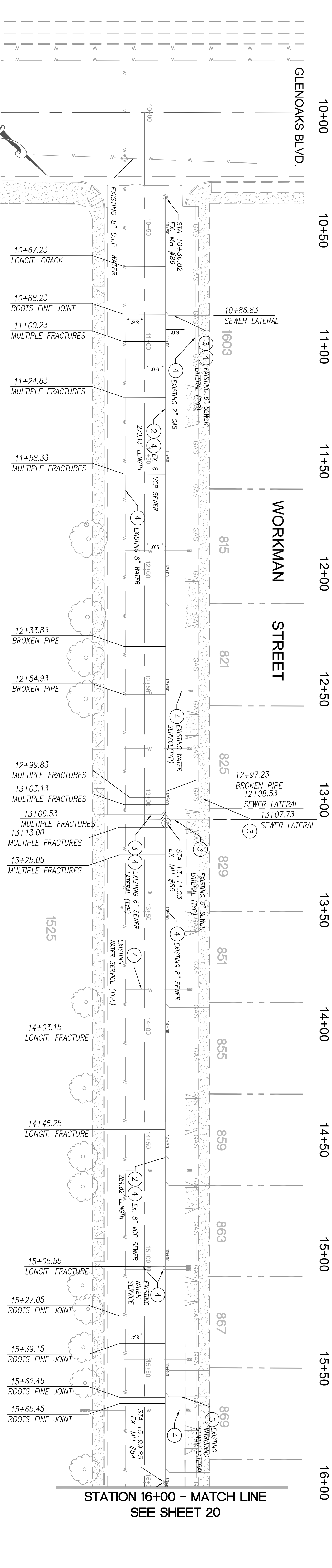
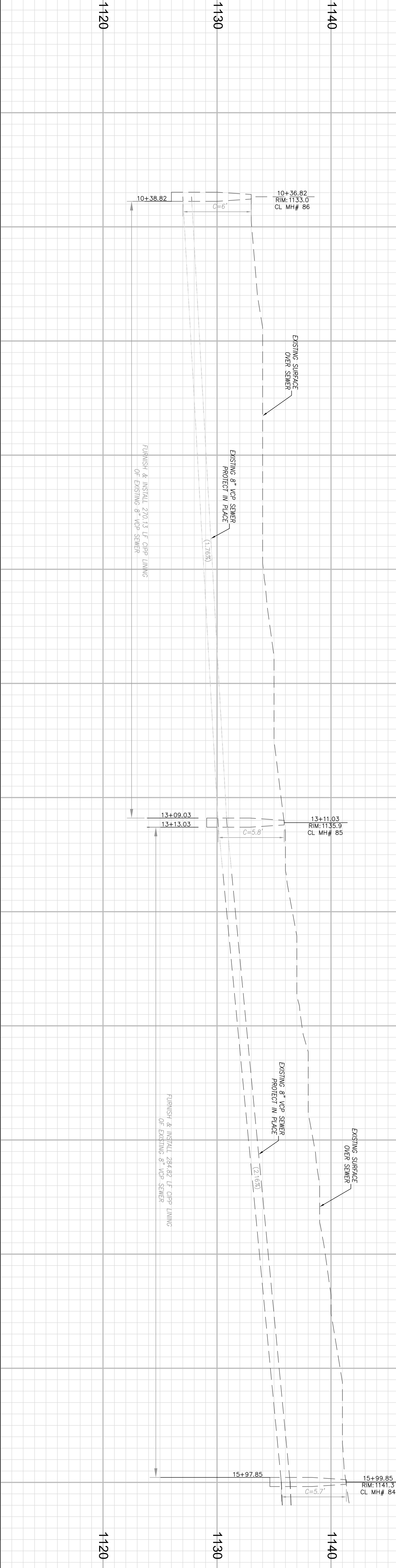

- ### CONSTRUCTION NOTES
- 1 FURNISH & INSTALL PIPE SLEEVE INTO EXISTING 8" VCP SEWER MAIN PER PROJECT SPECIFICATIONS
 - 2 FURNISH & INSTALL CIPP LINING OF EXISTING 8" VCP OR CONCRETE SEWER MAIN PER PROJECT SPECIFICATIONS
 - 3 RENSATE EXISTING 6" V.C.P. HOUSE CONNECTION PER PROJECT SPECIFICATIONS
 - 4 PROTECT EXISTING IN PLACE
 - 5 REMOVE PROTRUDING EXISTING SEWER LATERAL PRIOR TO CIPP LINING OR PIPE SLEEVE
- ### SEWER IMPROVEMENTS

811

Know what's below.
Call before you dig.

NUMBER

DATE

MINUS

APPROVAL

DATE

DATE

DATE

DATE

DATE

DATE

DATE

DATE

REVIEW ISSUANCES

BENCH MARK:

APPROVAL

SAN FERNANDO

PUBLIC WORKS DEPARTMENT

YING KWAN, P.E., CONSULTING CITY ENGINEER, ROC 42416

DATE

REGISTERED PROFESSIONAL ENGINEER

NO. 235

STATE OF CALIFORNIA

PLANS PREPARED UNDER THE SUPERVISION OF:

DATE:

DESIGN BY:

DATE:

DRAWN BY:

DATE:

CHECKED BY:

DATE:

CONSULTING CIVIL ENGINEERS

15669 EMERALD AVE., SUITE 100

IRVINE, CA 92614

(949) 867-8275 / (949) 867-8276 FAX

CONSULTING CIVIL ENGINEERS

15669 EMERALD AVE., SUITE 100

IRVINE, CA 92614

(949) 867-8275 / (949) 867-8276 FAX

2018-2019 ANNUAL STREET RESURFACING PROJECT

WORKMAN STREET
FROM GLENOAKS BOULEVARD TO SEVENTH STREET

CITY OF SAN FERNANDO

PLAN NO.

P-726

SHEET 19 OF 22

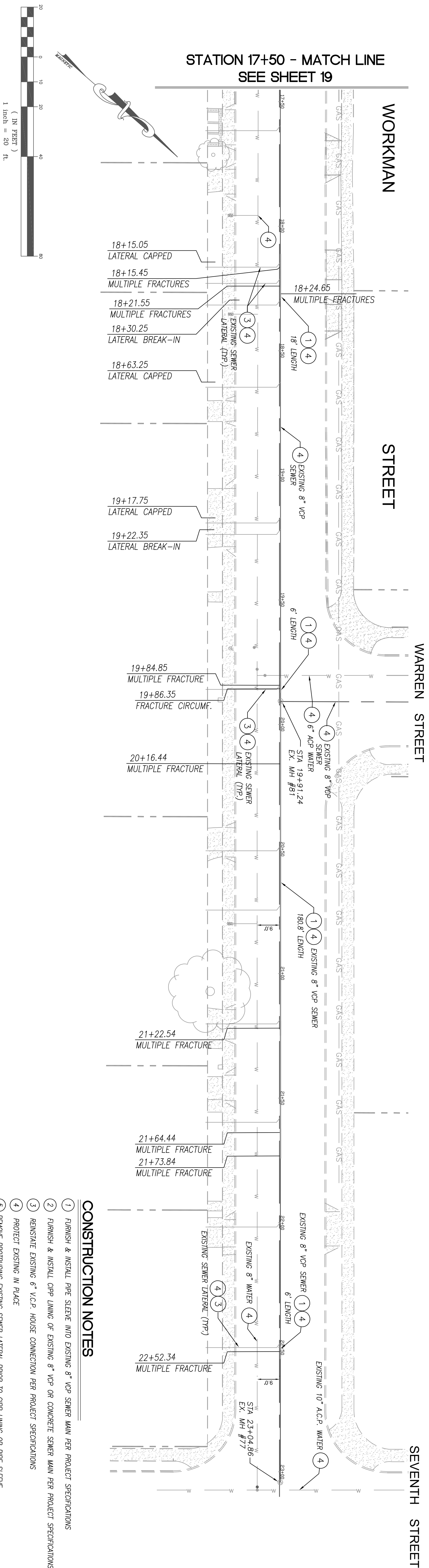
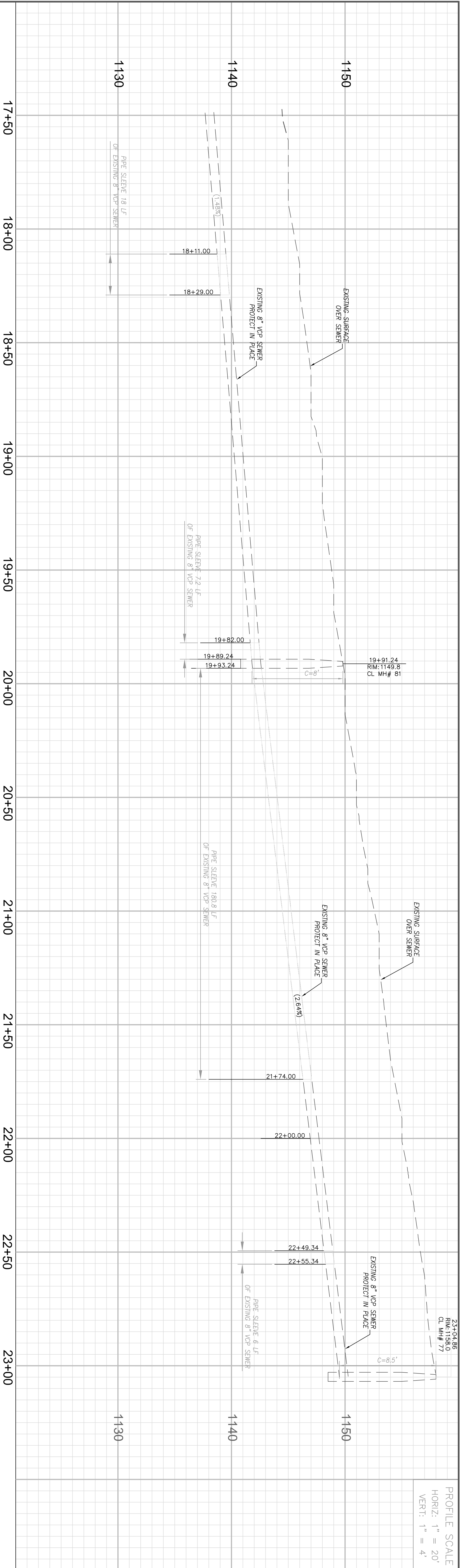

- 1 FURNISH & INSTALL PIPE SLEEVE INTO EXISTING 8" VOP SEWER MAIN PER PROJECT SPECIFICATIONS
- 2 FURNISH & INSTALL CIPP LINING OF EXISTING 8" VOP OR CONCRETE SEWER MAIN PER PROJECT SPECIFICATIONS
- 3 REINSTATE EXISTING 6" V.C.P. HOUSE CONNECTION PER PROJECT SPECIFICATIONS
- 4 PROTECT EXISTING IN PLACE
- 5 REMOVE PROTRUDING EXISTING SEWER LATERAL PRIOR TO CIPP LINING OR PIPE SLEEVE

SEWER IMPROVEMENTS

2018-2019 ANNUAL STREET RESURFACING PROJECT
WORKMAN STREET
FROM GLENOAKS BOULEVARD TO SEVENTH STREET
CITY OF SAN FERNANDO

PLAN NO.

P-726

SHEET 20 OF 22



**Know what's below.
Call before you dig.**

NAME		NUMBER		DATE	INITIALS	APPROD.	
RRE EW I SS I O O N S S							

BENCH MARK:



THE CITY OF
SAN FERNANDO
PUBLIC WORKS DEPARTMENT

YING KWAN, P.E., CONSULTING CITY ENGINEER, RCE 42418

DATE _____



PLANS PREPARED UNDER THE
JOAQUIN CERVANTES, JR., P.E.

DATE _____

DESIGN BY:	JC	4/20/2017
DRAWN BY:	DC	4/20/2017
CHECKED BY:	CA	5/30/2017

DRAWN BY:
CHECKED BY:

DRAWN BY:
CHECKED BY:

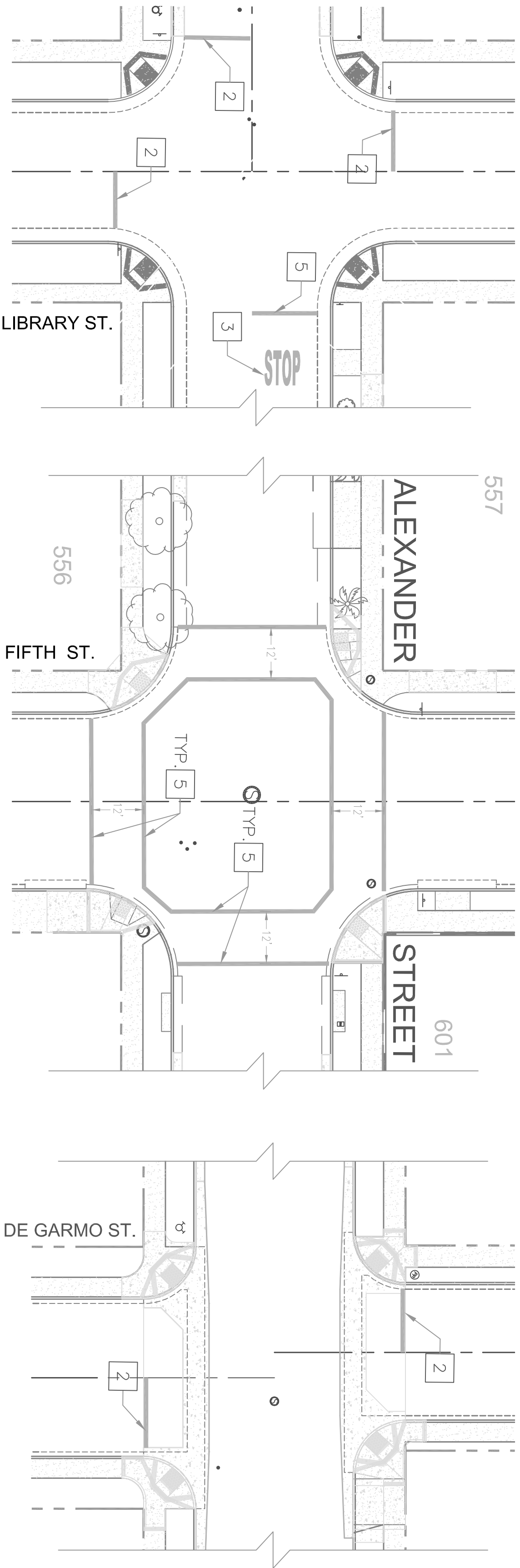

STRIPING NOTES

- 1 INSTALL CALTRANS DETAIL 2 WITH 50' LONG SOLID BREAK LINES AT INTERSECTION.
- 2 INSTALL 12" WIDE WHITE LIMIT/CROSSWALK LINE.
- 3 INSTALL PAVEMENT MARKING AS SHOWN.
- 4 INSTALL 4" DIAGONAL LINES @ 4' O.C.
- 5 INSTALL 12" WIDE YELLOW LIMIT/CROSSWALK LINE.
- 6 INSTALL CALTRANS DETAIL 21.

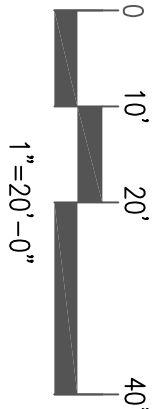
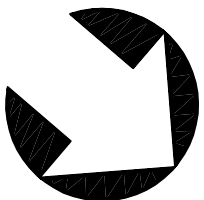
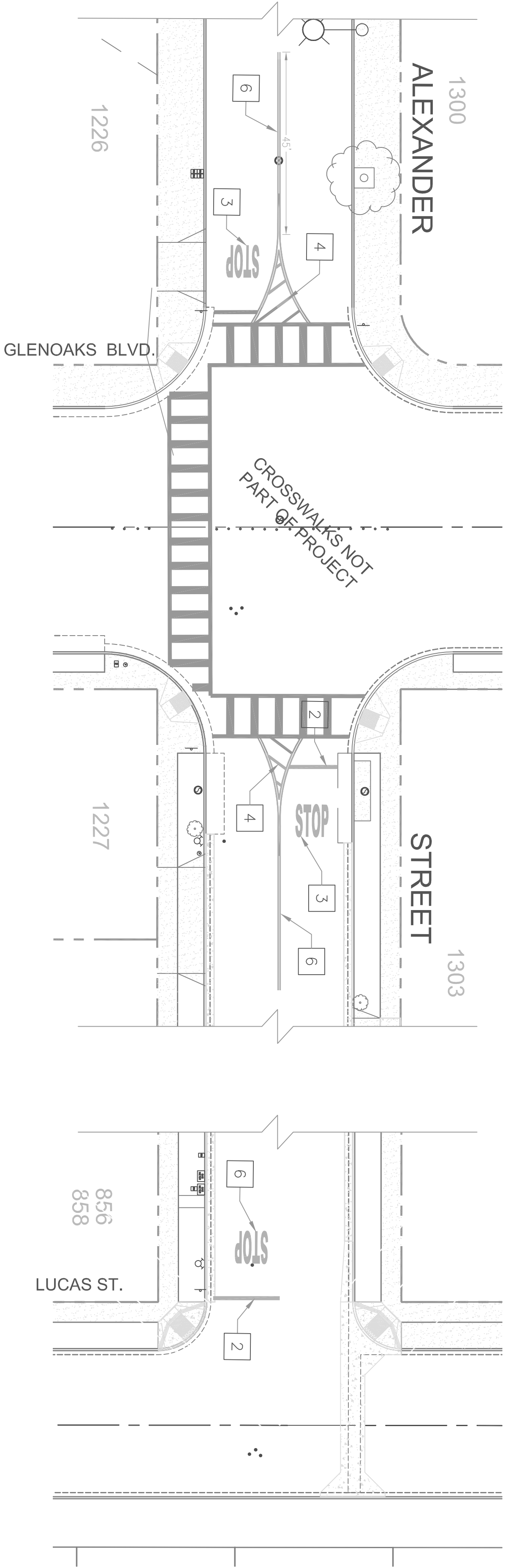



Know what's below.
Call before you dig.

NUMBER	DATE	INITIALS	APPROVAL

REVISIONS

BENCH MARK:



SAN FERNANDO
PUBLIC WORKS DEPARTMENT

YING KWAN, P.E., CONSULTING CITY ENGINEER, RCE 42418

DATE



Plans prepared by:



CONSULTING CIVIL ENGINEERS
1880 AVILA RD., SUITE B13
DOWNEY, CA 90241
(562) 997-9875 / (562) 997-2874 FAX

PLANS PREPARED UNDER THE SUPERVISION OF: JOAQUIN GERANTES, JR., P.E.

DATE: DESIGN BY: JC 4/20/2017
DRAWN BY: DC 4/20/2017
CHECKED BY: CA 5/30/2017

2018-2019 ANNUAL STREET RESURFACING PROJECT

ALEXANDER STREET
STRIPING PLAN

CITY OF SAN FERNANDO

PLAN NO.

P-726

SHEET 22 OF 22

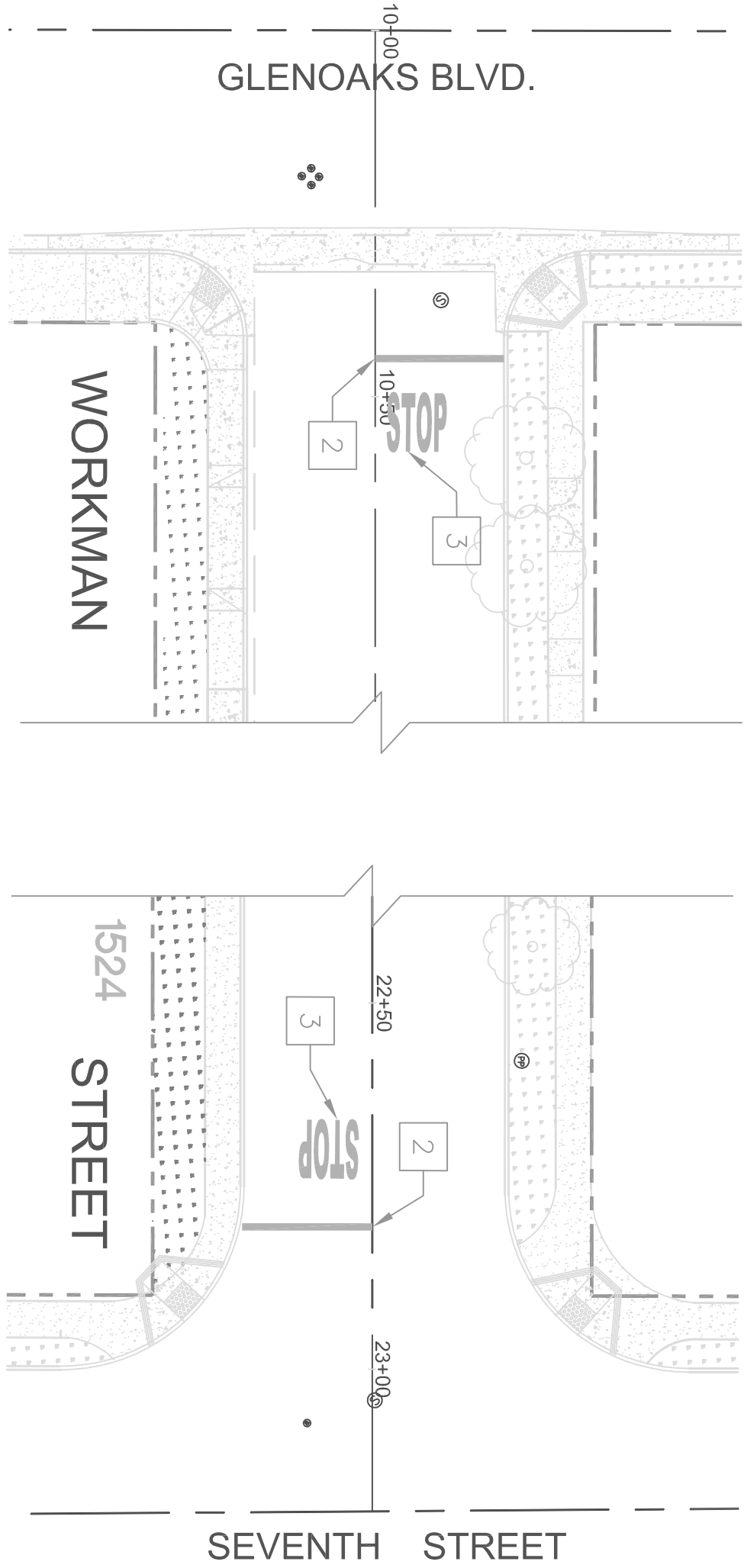
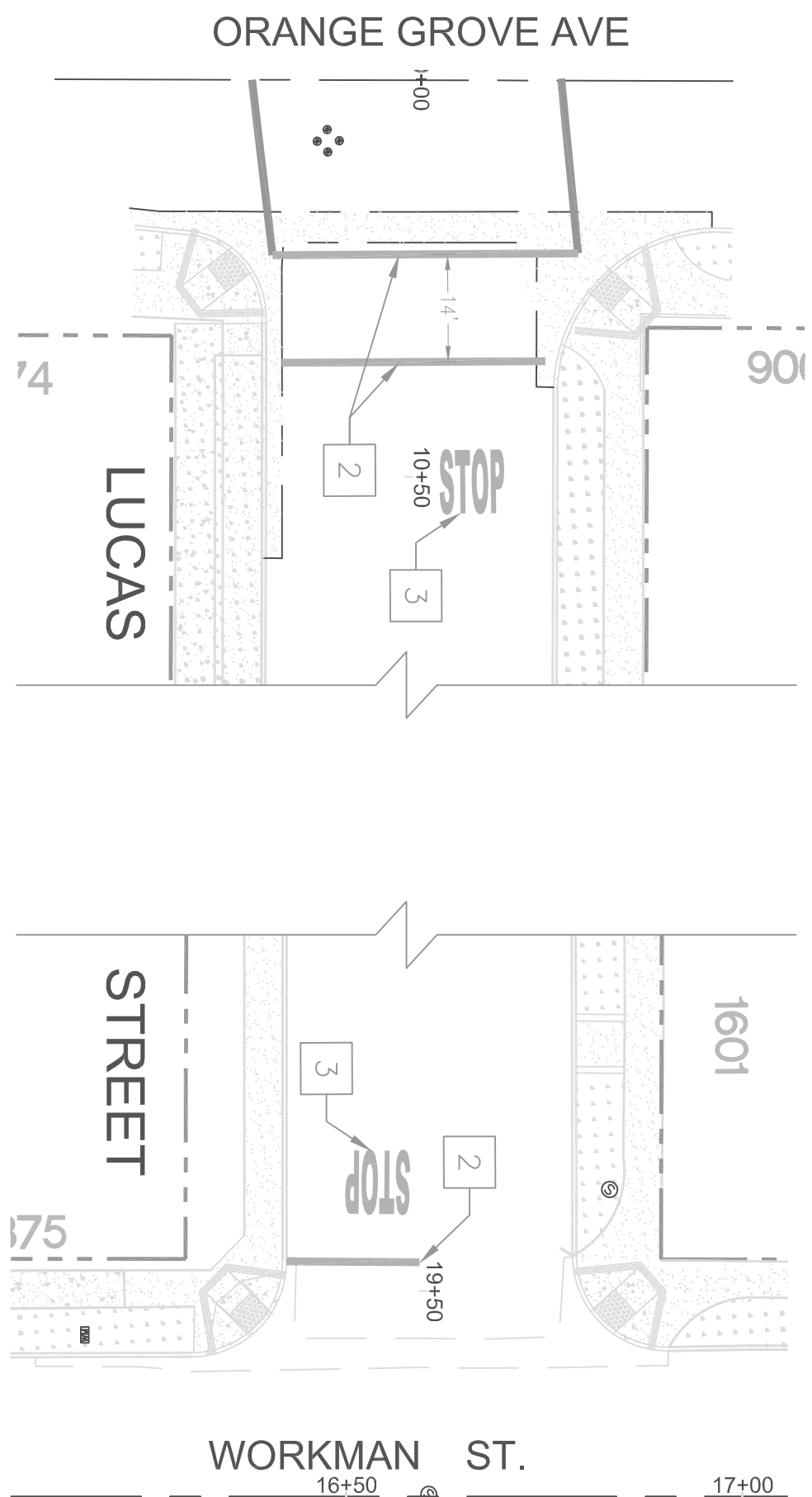
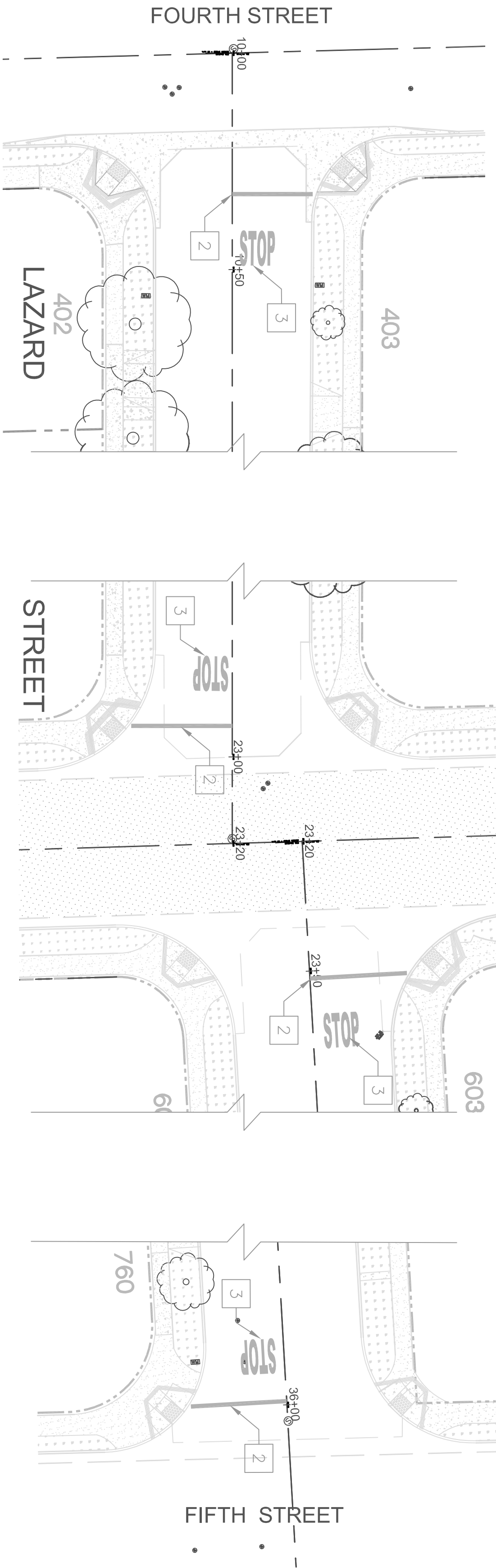

STRIPING NOTES

- 1
- INSTALL CALTRANS DETAIL 2 WITH 50' LONG SOLID BREAK LINES AT INTERSECTION.
- 2
- INSTALL 12" WIDE WHITE LIMIT/CROSSWALK LINE.
- 3
- INSTALL PAVEMENT MARKING AS SHOWN.
- 4
- INSTALL 4" DIAGONAL LINES @ 4' O.C.
- 5
- INSTALL 12" WIDE YELLOW LIMIT/CROSSWALK LINE.
- 6
- INSTALL CALTRANS DETAIL 21.

GENERAL NOTES

1.
- ALL STRIPING AND PAVEMENT MARKINGS SHALL BE THE RESPONSIBILITY OF THE CONTRACTOR AND SHALL CONFORM TO SECTION 84 AND 85 OF THE 2015 CALTRANS STANDARD SPECIFICATIONS AND THE APPROPRIATE DETAILS IN THE CALTRANS TRAFFIC MANUAL.
2.
- FOR ALL REFERENCES TO DETAILS OR FIGURES SHOWN HEREON, REFER TO THE 2015 CALTRANS STANDARD PLANS A20A - A20D AND A24A - A24E.
3.
- SIGNING AND STRIPING INSTALLATION SHALL NOT BE DONE WITHOUT THE WRITTEN APPROVAL OF THE CITY ENGINEER. PUBLIC WORKS INSPECTION, OR DESIGNER. ALL STRIPING CAT-PAKING AND SIGN LAYOUT SHALL BE INSPECTED BEFORE INSTALLATION. CONTACT THE PUBLIC WORKS INSPECTOR AT LEAST 24 HOURS IN ADVANCE TO SCHEDULE THE INSPECTION. THE CITY ENGINEER OR DESIGNER MUST APPROVE ANY CHANGES DUE TO PLAN DISCREPANCIES OR REVISIONS.
4.
- LANE WIDTHS SHALL BE MEASURED BETWEEN THE CENTER LINES OF EACH ADJACENT SINGLE OR DOUBLE STRIPE OR TOP OF CURB AS APPROPRIATE.
5.
- ALL LANE LINES AT INTERSECTION APPROACHES AND DEPARTURES SHALL BEGIN AND END WITH 50 FEET OF CONTINUOUS RAISED PAVEMENT MARKERS.
6.
- ALL GROSSWALKS, LIMIT LINES AND PAVEMENT MARKINGS SHALL BE THERMOPLASTIC.
7.
- PAINT SHALL BE APPLIED UNDER SUITABLE WEATHER CONDITIONS AND PER THE PAINT MANUFACTURER'S LABEL RECOMMENDATIONS FOR PAVEMENT AND AMBIENT TEMPERATURE REQUIREMENTS. PAINT SHALL NOT BE APPLIED IF RAIN IS FORECASTED WITHIN 24 HOURS.
8.
- THINNING OF PAINT SHOULD NOT BE ALLOWED.
9.
- ALL STRIPING SHALL INCLUDE RAISED PAVEMENT MARKERS (RPMS) PER THE APPROPRIATE CALTRANS TRAFFIC MANUAL DETAIL.
10.
- CONTRACTOR SHALL REMOVE ALL CONFLICTING PAINTED LINES, MARKINGS AND PAYMENT LEGENDS BY WET SANDBLASTING AND INCLUDES THE REMOVAL OF RAISED PAVEMENT MARKERS. SANDBLASTING DEBRIS SHALL BE REMOVED BEFORE THE END OF EACH WORK DAY.
11.
- NEW SIGNS SHALL BE HIGH INTENSITY SHEETING WITH GRAFFITI FILM.



Know what's below.
Call before you dig.

REVISIONS

NUMBER	DATE	INITIALS	APPROV.

BENCH MARK:



SAN FERNANDO

PUBLIC WORKS DEPARTMENT

YING KWAN, P.E., CONSULTING CITY ENGINEER, RCE 42418

DATE

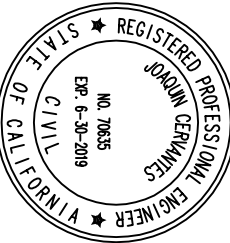

PLANS PREPARED UNDER THE SUPERVISION OF: **JOAQUIN CERVANTES, JR., P.E.**



CHE

Engineering, Inc.

CONSULTING CIVIL ENGINEERS

14800 AVALON BLVD., SUITE B13

(951) 957-1975 (951) 957-5021 FAX

DESIGN BY: **JC** 4/20/2017
DRAWN BY: **DC** 4/20/2017
CHECKED BY: **CA** 5/30/2017

2018-2019 ANNUAL STREET RESURFACING PROJECT

PLAN NO.

LAZARD ST./LUCAS ST./WORKMAN ST.

STRIPING PLAN

CITY OF SAN FERNANDO

SHEET **21** OF 22

P-726